



20120305000076120 1/4 \$21.00
Shelby Cnty Judge of Probate, AL
03/05/2012 09:43:22 AM FILED/CERT

ORDINANCE NUMBER 774-10A

AN ORDINANCE TO ALTER, REARRANGE AND EXTEND THE CORPORATE LIMITS OF THE CITY OF HELENA, ALABAMA, SO AS TO EMBRACE AND INCLUDE WITHIN THE CORPORATE AREA OF SAID CITY ALL TERRITORY NOW WITHIN SUCH CORPORATE LIMITS AND ALSO CERTAIN OTHER TERRITORY CONTIGUOUS TO SAID CITY.

WHEREAS, a petition signed by Judith Gay Reid the owner(s) of all of the land within the territory therein described and proposed to be annexed to the City, together with a map of said territory showing its relationship to the corporate limits of the City, has been filed with the City Clerk of the City of Helena; and

WHEREAS, this Council has determined and found that the matters set forth and alleged in said petition are true, and that it is in the public interest that said property be annexed to the City of Helena;

NOW, THEREFORE, BE IT ORDAINED by the Council of the City of Helena as follows:

Section 1. That said Council and the City of Helena hereby assent to the annexation of said territory to the City of Helena, Alabama, the corporate limits of the City to be extended and rearranged pursuant to the provisions of Chapter 42, Article 2, Code of Alabama 1975 (Sections 11-42-20 through 11-42-23, as amended) so as to embrace and include said territory in addition to the territory already within its present corporate limits, within the corporate area of said City, which said territory is not within the corporate limits of another municipality and the new boundary line does not lie at any point more than half the distance between the old city boundary and the corporate boundary of any municipality. Said territory is described as follows:

Helena, Alabama 35080
Parcel ID Number 12-8-28-0-000-010.004
Description

Section 2. That the City Clerk shall file a certified copy of this ordinance containing an accurate description of said annexed territory with the Probate Judge of Shelby County, Alabama, and also cause a copy of this ordinance to be posted in three (3) public places in the City of Helena and this ordinance to be sent to the Justice Department for their approval.

CERTIFICATION

I, Amanda C. Traywick, the duly appointed and acting Clerk of the City of Helena, Alabama, do hereby certify that the within Ordinance Number **774-10A** is a true copy as recited in the said City Clerk's Minute Book and posted by me as provided by law in three public places in said City, being on the bulletin board of the City Hall, in the BP Coosa Mart in the City of Helena, and in the Helena Public Library in said City, that said Ordinance shall become a duly lawful Ordinance of said City on the 27 day of February, 2010, five or more days after the posting of the same as provided by law.

IN WITNESS WHEREOF, I have hereunto set my hand and seal on this the 27 day of February, 2010.

[SEAL]



Amanda C Traywick
Amanda C. Traywick, City Clerk



20120305000076120 2/4 \$21.00
Shelby Cnty Judge of Probate, AL
03/05/2012 09:43:22 AM FILED/CERT

STATE OF ALABAMA
SHELBY COUNTY

I, Amanda C. Traywick, City Clerk of the City of Helena, do hereby certify that the above is a true correct copy of **Ordinance Number 774-10A** duly adopted by the Council of the City of Helena at its meeting held 22 day of February, 2010, and as same appears of record in the ordinance records of said City, and approved by the Mayor and City Council on 22 day of February, 2010.

Given under my hand and corporate seal of the City of Helena, this the 22 day of February, 2010.

[SEAL]



Amanda C Traywick
Amanda C. Traywick, City Clerk



20120305000076120 3/4 \$21.00
Shelby Cnty Judge of Probate, AL
03/05/2012 09:43:22 AM FILED/CERT

974-10A

Property Information - 12 8 28 0 000 010.004

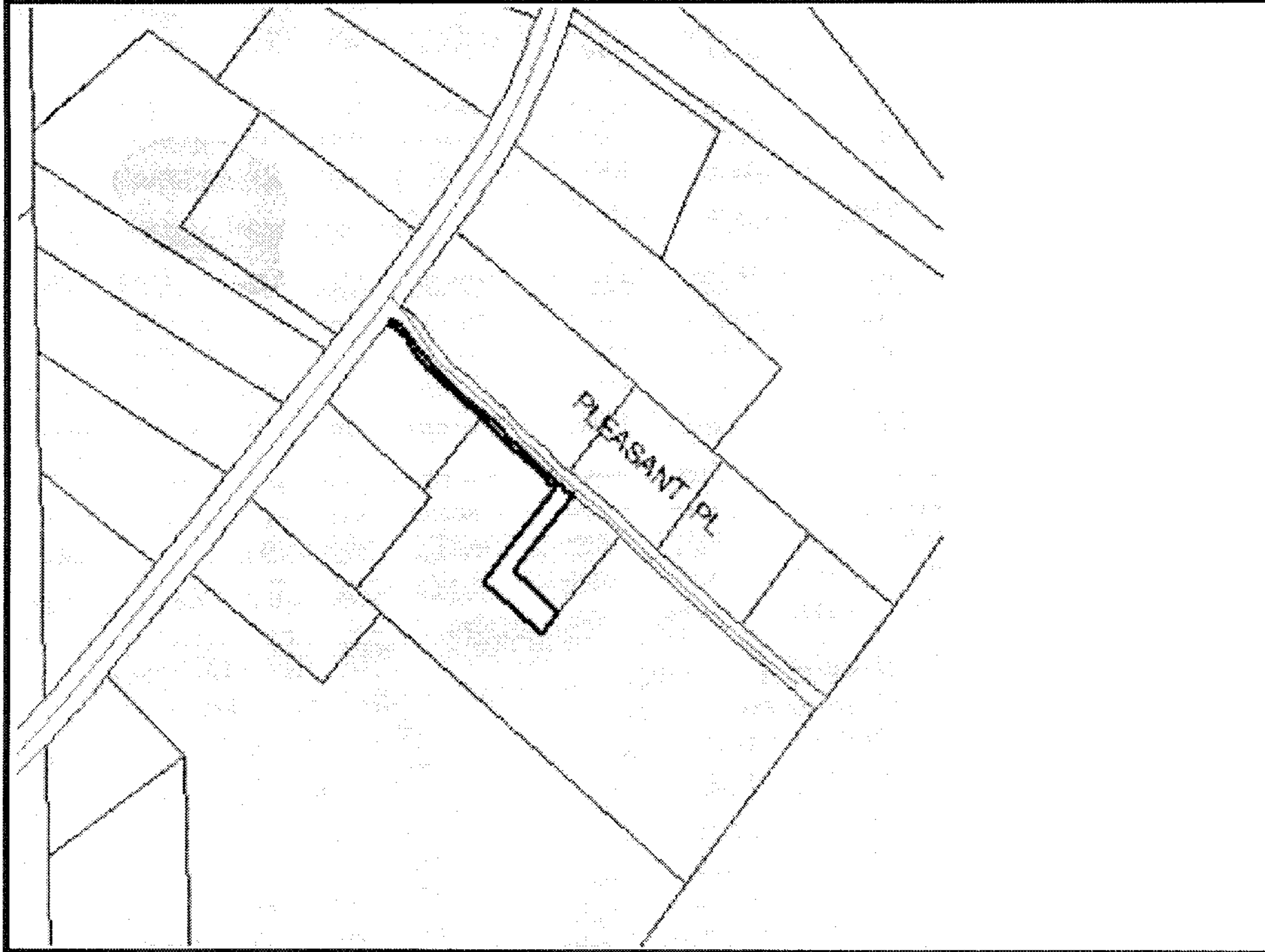

Owner Information

Name 1	Name2	Address 1	Address 2	City	State	Zip Code
REID JUDITH GAY		100 PLEASANT PLACE		BESSEMER	AL	35023
Subdivision	Primary Lot	Secondary Lot	Block	Section	Township	Range
				28	20S	04W
Map Book	Map Page	Lot Dimension 1	Lot Dimension 2	Number of Acres	Square Feet	
0	0	10	453.30000000000001	0.39000000000000001	16770.599999999999	

Description

COM NE COR NW1/4 SE1/4 SE1144 TO SW ROW PLEASANT PLACE & POB SE ALG ROW 453.3 SW179.98 SE114.7 SW49.92 NW145 NE220 NW423.6 TO SE ROW CO RD 1 NE ALG ROW 10 TO POB

Document Information

Recorded Date	Recorded Number
20070614	20070615000281470
20070614	20070615000281480



20120305000076120 4/4 \$21.00
Shelby Cnty Judge of Probate, AL
03/05/2012 09:43:22 AM FILED/CERT