

EASEMENT - DISTRIBUTION FACILITIES

STATE OF ALABAMA }
COUNTY OF Shelby }
W.E. No. A6170-05-AU-09
APCO Parcel No. 1022294
Transformer No. S-17261

This instrument prepared by: Larry D. Gravitt

Alabama Power Company
P. O. Box 2641
Birmingham, Alabama 35291

\$500.00

Shelby County, AL 06/18/2009

State of Alabama

Deed Tax : \$.50



20090618000233560 1/3 \$17.50
Shelby Cnty Judge of Probate, AL
06/18/2009 09:21:24 AM FILED/CERT

A. **GRANT** KNOW ALL MEN BY THESE PRESENTS, That Frederick D. Schaub and wife Mary Jo Schaub

Lessors

as grantors (s), (the "Grantor", whether one or more) for and in consideration of One and No/100 (\$1.00) and other good and valuable consideration, to Grantor in hand paid by Alabama Power Company, a corporation, the receipt and sufficiency of which are hereby acknowledged, does hereby grant to Alabama Power Company, its successors and assigns (the "Company"), the easements, rights and privileges described and designated in Section B below.

B. **RIGHTS** The easements, rights and privileges granted hereby are as follows:

1. **Overhead and/or Underground.** The right from time to time to construct, install, operate and maintain, upon, over, under and across the Property described in Section C below, along a route selected by the Company which is generally shown on the Company's drawing, attached hereto and made a part hereof, (which shows the general location of underground Facilities, if any, by indicating an area not greater than ten feet (10') in width), all poles, towers, wires, conduits, fiber optics, cables, trans closures, transformers, anchors, guy wires and other Facilities useful or necessary in connection therewith (collectively, "Facilities"), for the overhead and/or underground transmission and distribution of electric power, and also the right to clear and keep clear a strip of land extending five feet (5') to each side of the center line of underground Facilities and fifteen feet (15') to each side of the center line of overhead Facilities; further, the right in the future to install and utilize intermediate poles in line for overhead Facilities and the right to trim and cut and keep trimmed and cut all dead, weak, leaning or dangerous trees or limbs outside of the thirty foot (30') strip for overhead Facilities that, in the sole opinion of the Company, might now or may hereafter endanger, interfere with or fall upon any of the overhead Facilities.

2. **Line Clearing.** The right to trim and cut and keep trimmed and cut all dead, weak, leaning or dangerous trees or limbs that, in the sole opinion of the Company, might now or may hereafter endanger, interfere with or fall upon the electric transmission or distribution lines, poles, towers or other Facilities now or hereafter located adjacent to the Property described in Section C below along said route as selected by the Company generally shown on said drawing, and also the right to clear and keep clear all trees, undergrowth, and other obstructions on property in which Grantor has an interest within fifteen feet (15') of the center line of the lines of such poles, towers or other Facilities.

3. **Guy Wires and Anchors.** The right to implant, install and maintain anchor(s) of concrete, metal or other material on and under the Property described in Section C below, and to construct, extend and maintain guy wires from such anchor(s) to structures now or hereafter erected adjacent to such Property or property adjacent thereto (collectively, "Guy Wire Facilities") along said route selected by the Company generally shown on said drawing; and also the right to trim and cut and keep trimmed and cut all dead, weak, leaning or dangerous trees or limbs that, in the sole opinion of the Company, might now or may hereafter endanger, interfere with or fall upon any of the Guy Wire Facilities.

Grantor hereby grants to the Company all easements, rights and privileges necessary or convenient for the full enjoyment and use thereof, including without limitation the right of ingress and egress to and from the Facilities and Guy Wire Facilities, as applicable, and the right to excavate for installation, replacement, repair and removal thereof; and also the right to cut, remove and otherwise keep clear any and all structures, obstructions or obstacles of whatever character, on, under and above said Facilities and Guy Wire Facilities, as applicable.

C. **PROPERTY DESCRIPTION.** The easements, rights and privileges granted hereby shall apply to, and the word "Property" as used in this instrument shall mean, the following described real property situated in Shelby County, Alabama (the "Property"):

A parcel of land in the SW1/4 of the SW1/4 of Section 17,
Township 20 South, Range 1 West as is recorded in Deed Record
20041028000595150 in the office of the Judge of Probate of
Shelby County, Alabama.

D. **ADDITIONAL PROVISIONS.** In the event it becomes necessary or desirable for the Company to move any of the Facilities in connection with the construction or improvement of any public road or highway in proximity to the Facilities, Grantor hereby grants to the Company the right to relocate the Facilities and, as to such relocated Facilities, to exercise the rights granted above; provided, however, the Company shall not relocate the Facilities on the Property at a distance greater than ten feet (10') outside the boundary of the right of way of any such public road or highway as established or re-established from time to time. This grant and agreement shall be binding upon and shall inure to the benefit of Grantor, the Company and each of their respective heirs, personal representatives, successors and assigns and the words "Company" and "Grantor" as used in this instrument shall be deemed to include the heirs, personal representatives, successors and assigns of such parties.

TO HAVE AND TO HOLD the same to the Company, its successors and assigns, forever.

IN WITNESS WHEREOF, the undersigned Grantor(s) has/have set his/her their hand(s) and seal(s) this the 28 day of May, 2009.

Witness

(Grantor)

(Grantor)

Witness

(Grantor)

Witness

By:

As:

For Alabama Power Company Corporate Real Estate Department Use Only

All facilities on Grantor: _____

Station to Station: _____

Sta # 1400 to Sta # 1440 (only)

Lessors

IN WITNESS WHEREOF, the said Grantor, has caused this instrument to be executed by _____ its authorized representative, as of the _____ day of _____, 20_____.

ATTEST (if corporation) or WITNESS:

By: _____
Its: _____

(Grantor - Name of Corporation/Partnership/LLC)
By: _____ (SEAL)
Its: _____
[indicate President, General Partner, Member, etc.]

INDIVIDUAL NOTARIES

STATE OF ALABAMA }
COUNTY OF Shelby }

I, the undersigned, a Notary Public, in and for said County in said State, hereby certify that Frederick D. Schaub and wife
Mary Jo Schaub whose name(s) ~~is~~ are signed to the foregoing instrument and who ~~is~~ are known to me, acknowledged before me on this day that being informed of the contents of the instrument, ~~he/she~~ they executed the same voluntarily, on the day the same bears date.
Given under my hand and official seal this the 28th day of May, 2009.

[SEAL]

Mary D. Givitt
Notary Public
My commission expires: 2-6-10

STATE OF ALABAMA }
COUNTY OF _____ }

I, the undersigned, a Notary Public, in and for said County in said State, hereby certify that _____
_____ whose name(s) is/are signed to the foregoing instrument and who is/are known to me, acknowledged before me on this day that being informed of the contents of the instrument, he/she/they executed the same voluntarily, on the day the same bears date.
Given under my hand and official seal this the _____ day of _____, _____.

[SEAL]

Notary Public
My commission expires: _____

TRUSTEE/CORPORATION/PARTNERSHIP/LLC NOTARY

STATE OF ALABAMA }
COUNTY OF _____ }

I, the undersigned, a Notary Public, in and for said County in said State, hereby certify that _____
_____, whose name as _____ of _____
_____ a _____, is signed to the foregoing instrument, and who is known to me, acknowledged before me on this day that being informed of the contents of the instrument, he/she, as such _____ and with full authority, executed the same voluntarily for and as the act of said _____ [acting in such capacity as aforesaid].
Given under my hand and official seal, this the _____ day of _____, _____.

[SEAL]

Notary Public
My commission expires: _____

20090618000233560 2/3 \$17.50
Shelby Cnty Judge of Probate, AL
06/18/2009 09:21:24 AM FILED/CERT

Sketch of Proposed Work – Simplified W. E.

Customer ATT	Location 1002 Hwy 74	Agreed Serv. Date 6-30-09	County SHELBY	Section 17	Township 205	Range 10	Add'l Info	Estimate No. A6170 DS AUG 09
Division BIRMINGHAM	Operation METRO-SOUTH	Town CHELSEA	Engineer FRDST	LINC# 11060	Date 5-20-09	Substation CHELSEA	NJUNS Ticket # 34724	LOC Transformer Loading

Customer To Install 34" PVC Conduit
At A Depth Of 18" Less Than 30"
w/ Pull String
APRO TO BILL ATT IN THE
HARBOR OF #334.11 PER UCD CSP

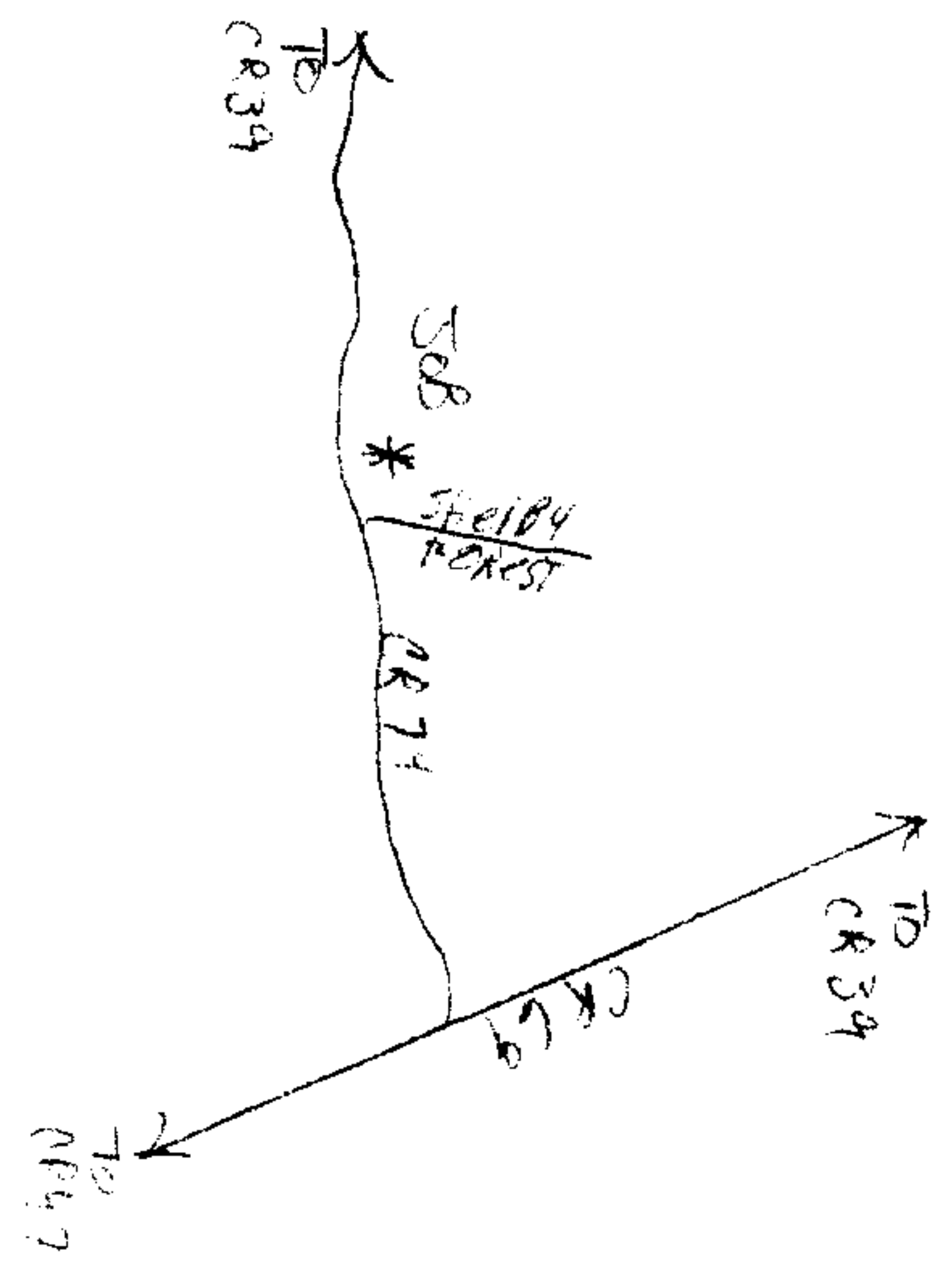
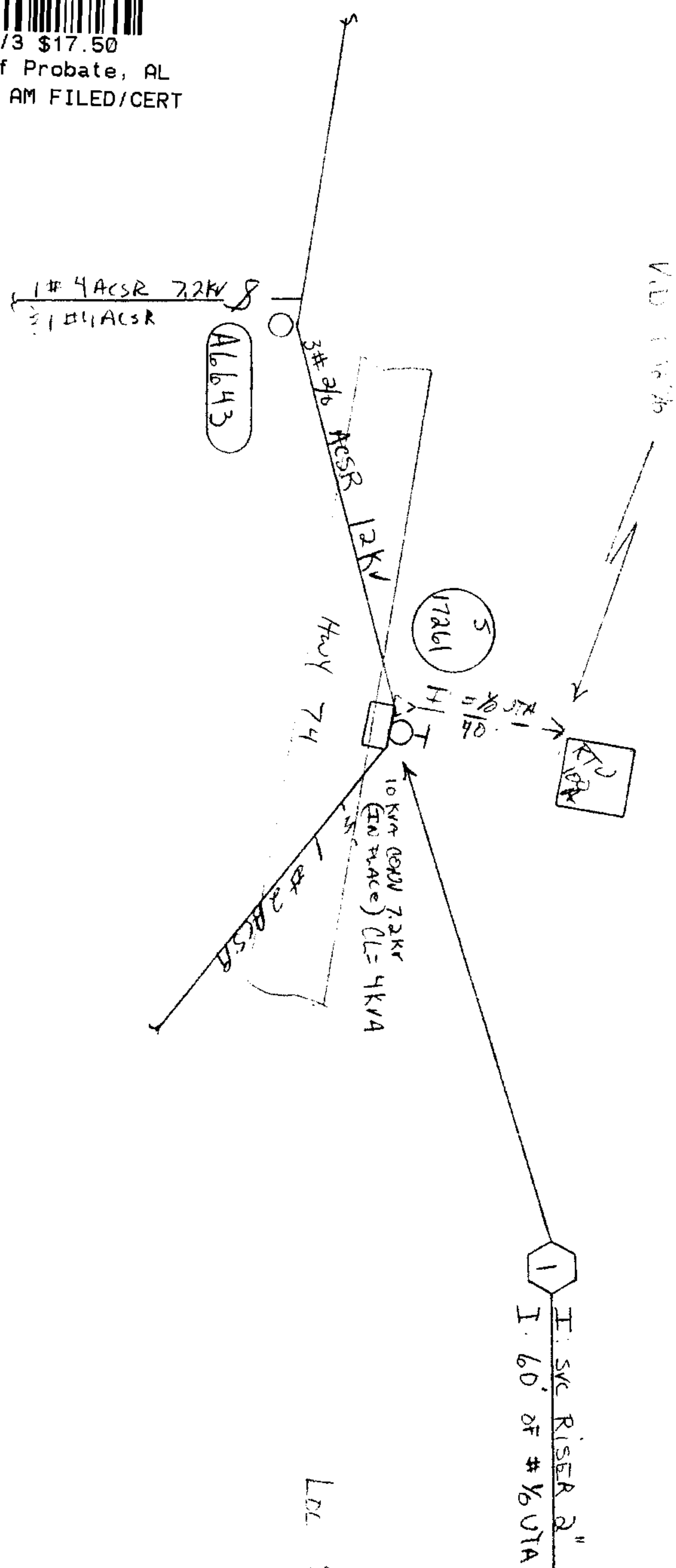

SHORT CIRCUITS 3Ø - G= Ø - G= Ø - G Res=	ENERGIZED LINE WORK SUB _____ OCB/OCR# _____ SWITCH# _____ FUSE SIZE _____
---	--

"MISS-ALL" # 1-800-292-8525 DATE CALLED _____ LOCATION REQUEST # _____ WATER WORKS DATE CALLED _____	TRANSFER OF ATTACHMENTS YES NO OTHER _____ KNOWLEDGE _____ CHARTER _____ OTHER _____
--	---

target
ZERO
ONE DAY AT A TIME
PERFORM
JSA

Pri	Sec	Voltage
120	240	
PHONE CO.		
Co. Name		
CATV CO.		
Co. Name		
Accessible Heavy Traffic SW Amp		
TREE CREW		
PERMITS REC'D		
R/W		
CITY		
COUNTY		
STATE		
OTHER		
SCALE		
NTS		
Ft. Per Inch		

20090618000233560 3/3 \$17.50
Shelby Cnty Judge of Probate, AL
06/18/2009 09:21:24 AM FILED/CERT

Cnst. Completed By _____ Date _____