

**ORDINANCE NUMBER 780-08A**

**AN ORDINANCE TO ALTER, REARRANGE AND EXTEND THE CORPORATE LIMITS OF THE CITY OF HELENA, ALABAMA, SO AS TO EMBRACE AND INCLUDE WITHIN THE CORPORATE AREA OF SAID CITY ALL TERRITORY NOW WITHIN SUCH CORPORATE LIMITS AND ALSO CERTAIN OTHER TERRITORY CONTIGUOUS TO SAID CITY.**

**WHEREAS**, a petition signed by Sarah H. Garner the owner(s) of all of the land within the territory therein described and proposed to be annexed to the City, together with a map of said territory showing its relationship to the corporate limits of the City, has been filed with the City Clerk of the City of Helena; and

**WHEREAS**, this Council has determined and found that the matters set forth and alleged in said petition are true, and that it is in the public interest that said property be annexed to the City of Helena;

**NOW, THEREFORE, BE IT ORDAINED** by the Council of the City of Helena as follows:

**Section 1.** That said Council and the City of Helena hereby assent to the annexation of said territory to the City of Helena, Alabama, the corporate limits of the City to be extended and rearranged pursuant to the provisions of Chapter 42, Article 2, Code of Alabama 1975 (Sections 11-42-20 through 11-42-23, as amended) so as to embrace and include said territory in addition to the territory already within its present corporate limits, within the corporate area of said City, which said territory is not within the corporate limits of another municipality and the new boundary line does not lie at any point more than half the distance between the old city boundary and the corporate boundary of any municipality. Said territory is described as follows:

4481 South Shades Crest Road

Bessemer, Alabama 35023

Parcel ID Number 58-12-6-13-0-000-009.000

Description

BEG INT W LN NW 1/4 NW 1/4 & S R/W SHADES CREST RD NELY ALG SD R/W 170' TO POB NELY 151.84SELY SWLY TO S LN SD1/4 1/4 WLY 110.9 NLY TO POB



20081106000430220 1/5 \$23.00  
Shelby Cnty Judge of Probate, AL  
11/06/2008 10:44:56AM FILED/CERT

**Section 2.** That the City Clerk shall file a certified copy of this ordinance containing an accurate description of said annexed territory with the Probate Judge of Shelby County, Alabama, and also cause a copy of this ordinance to be posted in three (3) public places in the City of Helena and this ordinance to be sent to the Justice Department for their approval.

**STATE OF ALABAMA**  
**SHELBY COUNTY**

I, Peggy C. Dunaway, City Clerk of the City of Helena, do hereby certify that the above is a true correct copy of **Ordinance Number 780-08A** duly adopted by the Council of the City of Helena at its meeting held 20 day of October, 2008, and as same appears of record in the ordinance records of said City, and approved by the Mayor and City Council on 20 day of October, 2008.

Given under my hand and corporate seal of the City of Helena, this the 20 day of October, 2008.

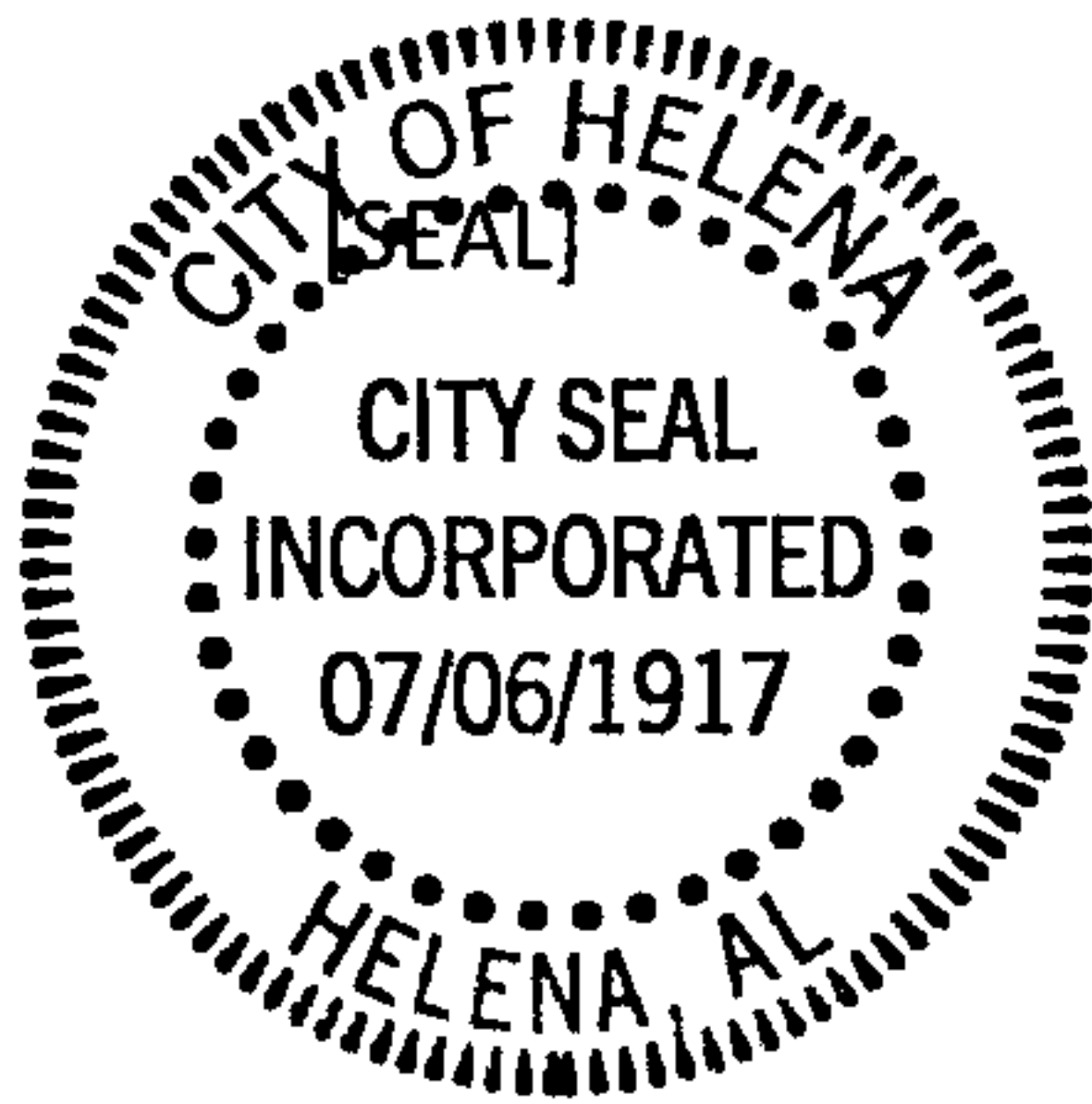

Peggy C. Dunaway  
Peggy C. Dunaway, City Clerk

  
20081106000430220 2/5 \$23.00  
Shelby Cnty Judge of Probate, AL  
11/06/2008 10:44:56AM FILED/CERT

# CERTIFICATION

I, Peggy C. Dunaway, the duly appointed and acting Clerk of the City of Helena, Alabama, do hereby certify that the within Ordinance Number **780-08A** is a true copy as recited in the said City Clerk's Minute Book and posted by me as provided by law in three public places in said City, being on the bulletin board of the City Hall, in the BP Coosa Mart in the City of Helena, and in the Helena Public Library in said City, that said Ordinance shall become a duly lawful Ordinance of said City on the 27 day of October, 2008, five or more days after the posting of the same as provided by law.

IN WITNESS WHEREOF, I have hereunto set my hand and seal on this the 20 day of October, 2008.



Peggy C. Dunaway  
Peggy C. Dunaway, City Clerk

  
20081106000430220 3/5 \$23.00  
Shelby Cnty Judge of Probate, AL  
11/06/2008 10:44:56AM FILED/CERT

**PETITION**

I/we, Sarah H. Garner the undersigned property owner(s), being owners of all of the land within the territory described as follows:

BEG INT W LN NW 1/4 NW 1/4 & S R/W SHADES  
CREST RD NELY ALG SD R/W 170' TO POB  
NELY 151.84 SELY SWLY TO S LN SD 1/4 1/4 WLY  
110.9 NLY TO POB

SEC: 13 T: 20S R: 04W

do hereby petition the City of Helena, County of Shelby, Alabama, to annex the above described property into the city limits of the City of Helena. Attached hereto as Exhibit 'A' and made part and parcel hereof as fully as if set out herein, is a map of said property which we own, showing its relationship to the corporate limits of the City of Helena, Alabama, which said map is herewith filed with the City Clerk of the City of Helena, Alabama.

Dated this 15 day of Sept, 2008.

Parcel # & Address

Name & Phone

12 6 13 0 000 009.000  
4481 S SHADES CREST RD.  
BESSMER, AL 35022

SARAH H. GARNER  
(205) 428-7767

How many people live on the parcel of land, how many are of voting age, how many are not of voting age and the race of each person.

ONE  
WHITE

  
20081106000430220 4/5 \$23.00  
Shelby Cnty Judge of Probate, AL  
11/06/2008 10:44:56AM FILED/CERT

Reason for annexation

Police & Fire Protection

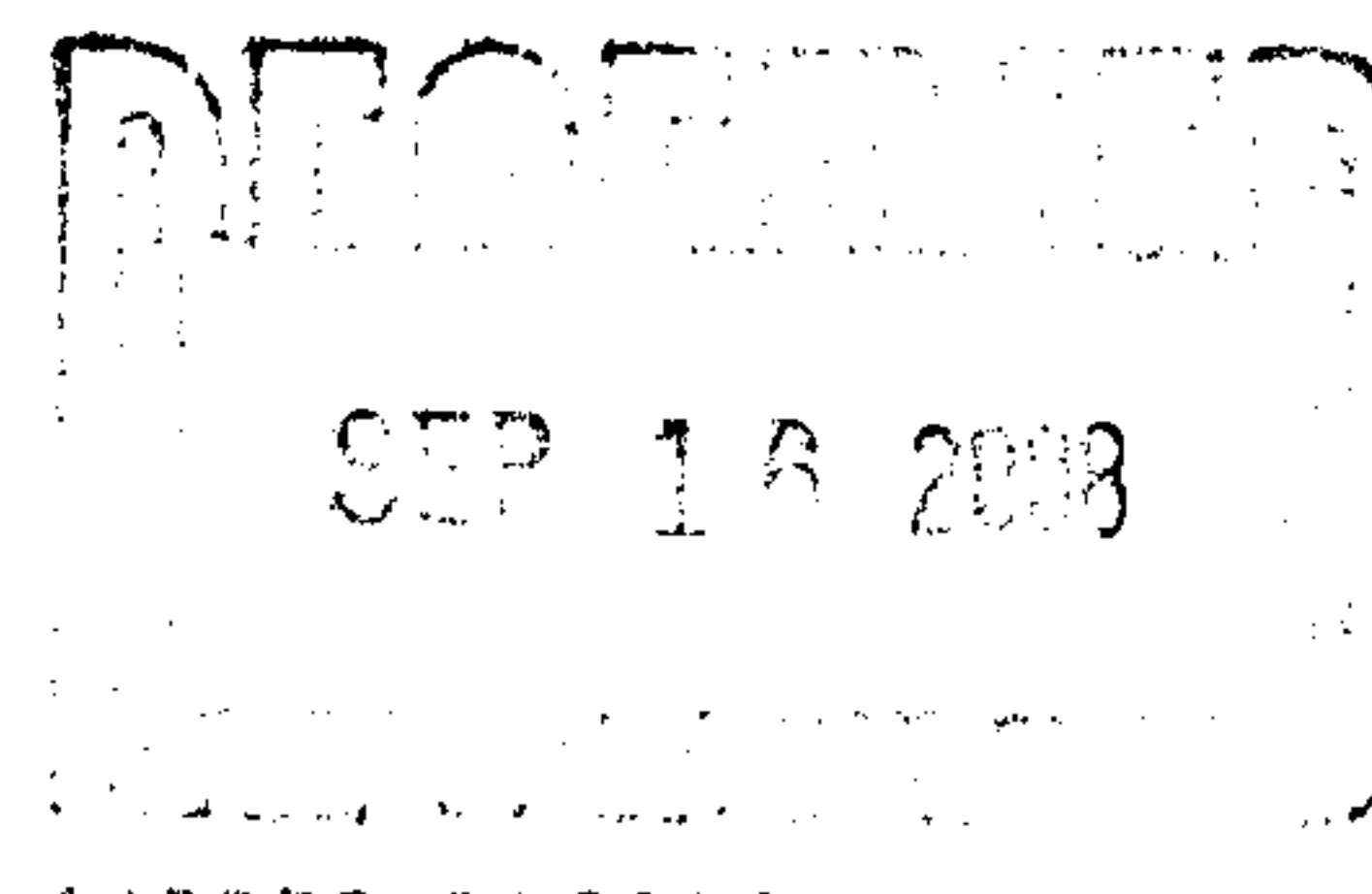

780-08A

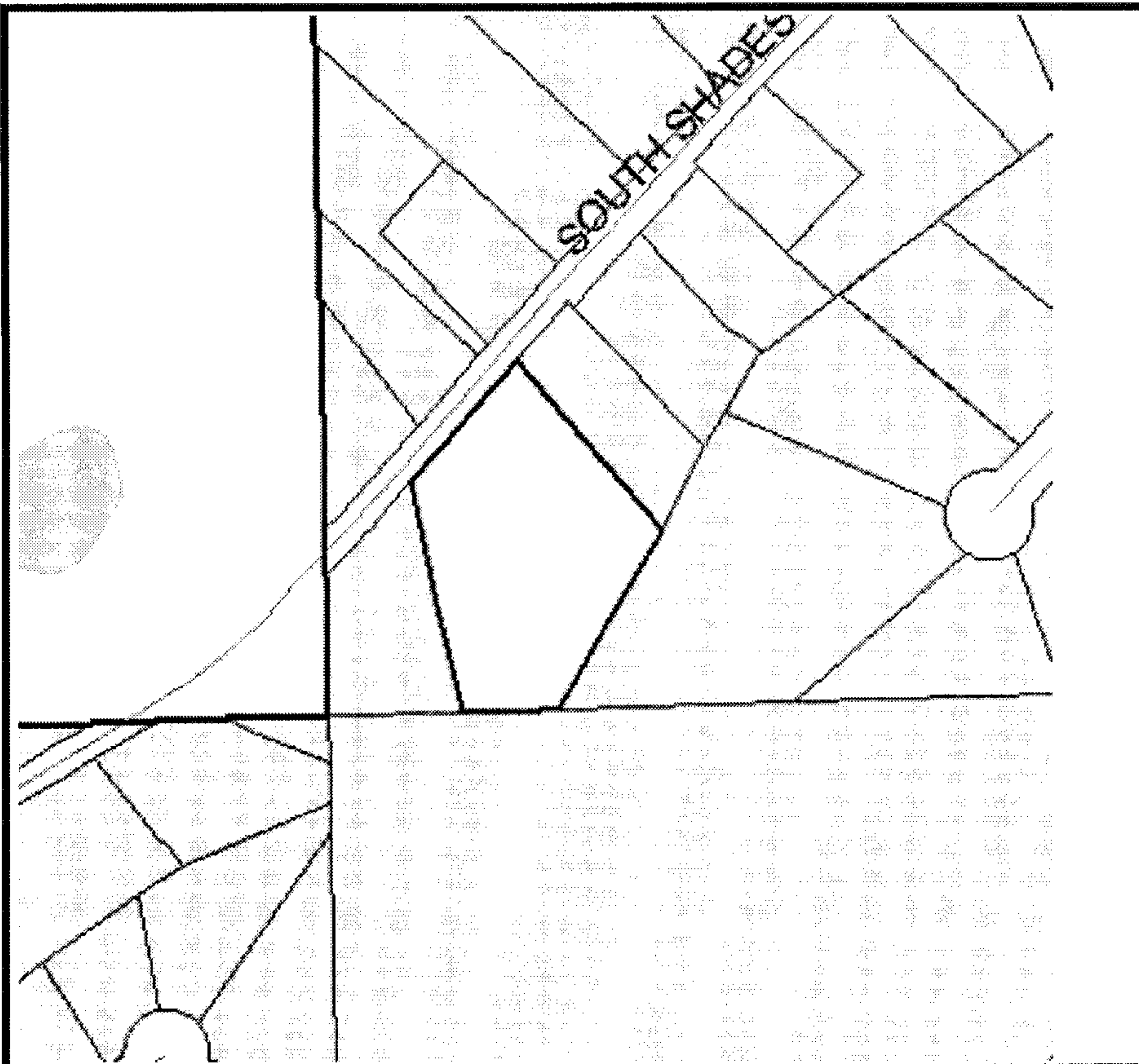

**Property Information - 12 6 13 0 000 009.000****Owner Information**

Name 1	Name2	Address 1	Address 2	City	State	Zip Code
GARNER SARAH H		4481 S SHADES CREST RD		BESSEMER	AL	35023
Subdivision	Primary Lot	Secondary Lot	Block	Section	Township	Range
			000	13	20S	04W
Map Book	Map Page	Lot Dimension 1	Lot Dimension 2	Number of Acres	Square Feet	
0	0	151.84	327.80000000000001	0	0	

**Description**

BEG INT W LN NW1/4 NW1/4 & S R/W SHADES CREST RD NELY ALG SD R/W 170' TO POB NELY 151.84SELY SWLY TO S LN SD1/4 1/4 WLY 110.9 NLY TO POB

**Document Information**

Recorded Date	Recorded Number
---------------	-----------------



20081106000430220 5/5 \$23.00  
Shelby Cnty Judge of Probate, AL  
11/06/2008 10:44:56AM FILED/CERT