

ORDINANCE 2008-0617

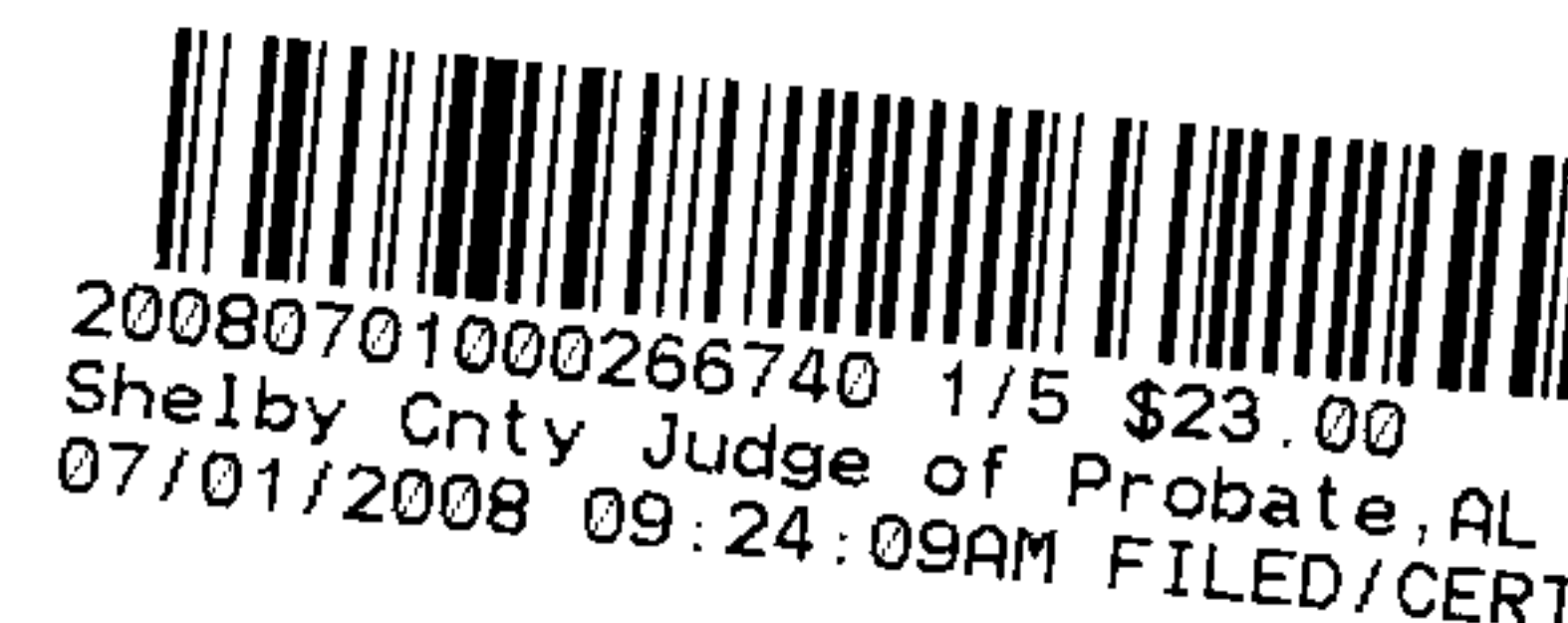

Councilman Deborah Logan introduced the following Ordinance:

WHEREAS, on the 16th day of June, 2008

The persons whose names are signed thereto, filed a petition with the Clerk of the Town of Harpersville as required by Section 11-42-20 and 11-42-21, Code of Alabama 1975, petitioning And requesting that the property hereinafter described be annexed to the municipality of the Town of Harpersville, Alabama and requesting the Mayor and Council of said Town to adopt an Ordinance assenting to the annexation of said property to such municipality, which petition Contained and accurate description of the property or territory proposed to be annexed together With a map of said territory showing its relationship to the corporate limits of the Town of Harpersville, and the signatures of the owners of the property or territory described were signed Thereto;

NOW, THEREFORE, BE IT ORDAINED BY THE MAYOR AND COUNCIL OF THE TOWN OF HARPERSVILLE, ALABAMA AS FOLLOWS:

That the Town of Harpersville does adopt this ordinance assenting to the annexation of The following described property or territory to the municipality of the Town of Harpersville.

Said Property being described on Exhibit "A" attached hereto.

Be it further ordained that the corporate limits of the Town of Harpersville be extended An rearranged so as to embrace and include such property and such property or territory shall Become a part of the corporate area of such municipality upon the date of publication of this Ordinance, as provided for in section 11-42-20 and 11-42-21, Code of Alabama 1975.

Be it further ordained that the Clerk is hereby authorized and directed to file a copy of This ordinance, along with an accurate description of the property or territory being annexed, Together with a map of the said property or territory showing its relationship to the corporate Limits of the Town of Harpersville to which said territory or property is being presented to the Office of the Department of Justice for approval.

Be it further ordained that the Zoning Map of the Town of Harpersville, and any other Official maps or surveys of the Town, shall be amended to reflect the annexation of properties Being presented for approval.

MAYOR

ATTEST: Joyce Roberts, Clerk

TOWN OF HARPERSVILLE
PETITION FOR UNANIMOUS CONSENT

20080701000266740 2/5 \$23.00
Shelby Cnty Judge of Probate, AL
07/01/2008 09:24:09AM FILED/CERT

We the undersigned, constituting all of the hereinafter described real property do hereby execute and file with the Town of Harpersville clerk this written petition asking and requesting that our property hereinafter described be annexed to the town of Harpersville, under authority of section 11-42-20 throughout 11-42-24 code of Alabama, 1975.

Said property is described as follows:

Property Owners: *Walter R & Julie D. Higgins*
Tax ID #: *Walter R. Higgins Julie D. Higgins*

See attached Map and Property Inquiry for legal description.

We further certify that said property is contiguous to the Town of Harpersville. We further certify that all the property included in the above described which lies within the police jurisdiction of both the annexing municipality and another municipality is located closer to the annexing municipality than to the other municipality as required by sections 11-42-21 code of Alabama, 1975

Parcel # 17 6 13 0 000 005.003- 4.70 acres

Parcel # 17 6 24 0 000 001.000- 54 acres



20080701000266740 3/5 \$23.00
Shelby Cnty Judge of Probate, AL
07/01/2008 09:24:09AM FILED/CERT

ANNEXATION CHECK LIST

Copy of petition signed by property owners	
Map of Property	
Description of Property	
Names of Property Owners	WALTER R HIGGINS Julie D. Higgins
How many single family dwellings on property	1
How many people live on parcel of land	2
How many are of voting age	2
How many are not of voting age	0
The race of each person	White
Reason for annexation	Benefits of being in city.

Property Information - 17 6 13 0 000 005.003

20080701000266740 4/5 \$23.00
Shelby Cnty Judge of Probate, AL
07/01/2008 09:24:09AM FILED/CERT

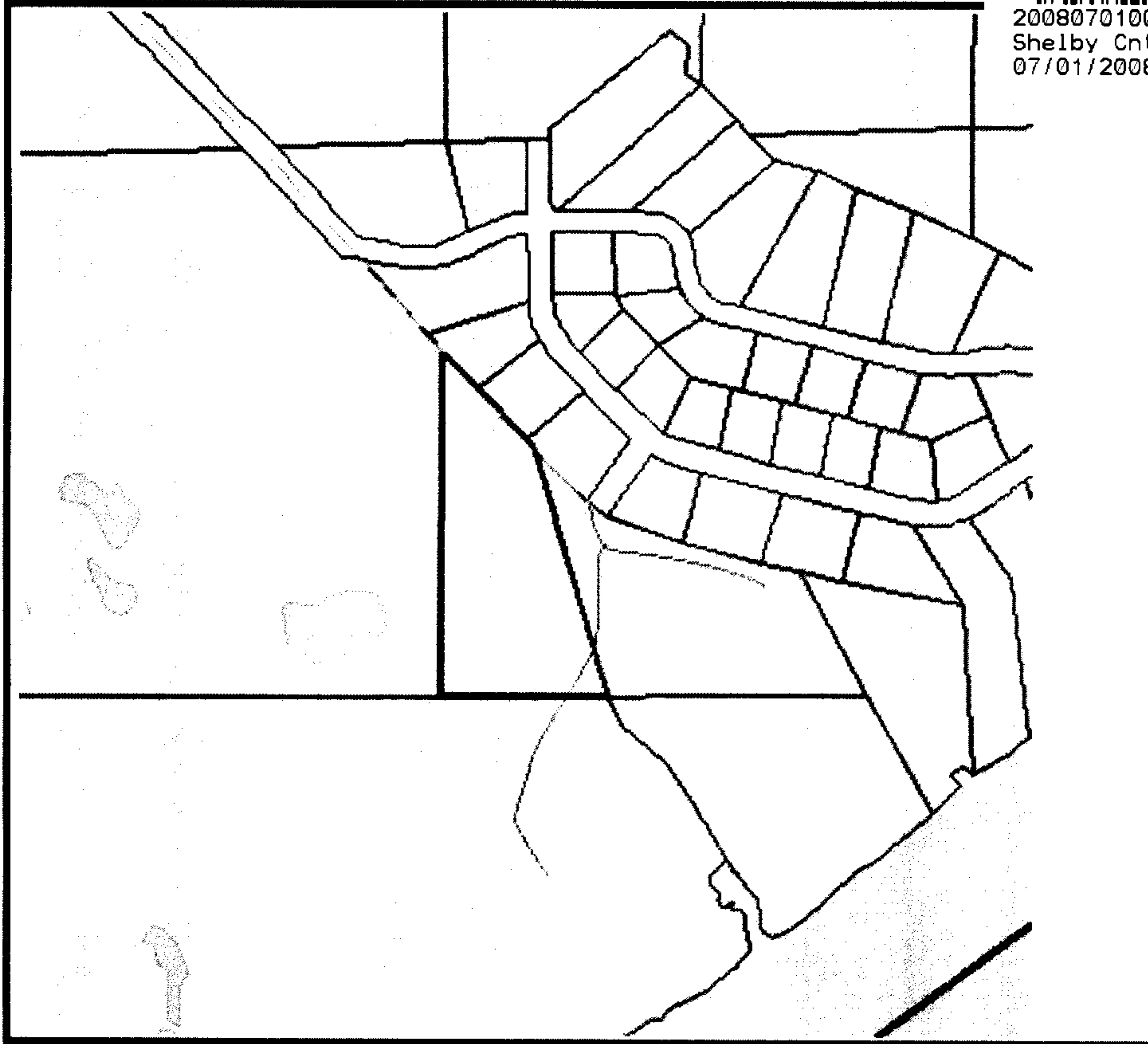
**Owner Information**

Name 1	Name2	Address 1	Address 2	City	State	Zip Code
HIGGINS WALTER R SR & JULIA D		1296 CHANCELLOR FERRY RD		HARPERSVILLE	AL	35078
Subdivision	Primary Lot	Secondary Lot	Block	Section	Township	Range
			000	13	20S	02E
Map Book	Map Page	Lot Dimension 1	Lot Dimension 2	Number of Acres	Square Feet	
0	0	316.44	760	4.7000000000000002	204732	

Description

BEG SW COR SW1/4 SE1/4 N760(S) SE537.59 TO S LN SEC 13 W ALG SEC LN 362.92 TO POB

Document Information

Recorded Date	Recorded Number
19950821	19950002334300000

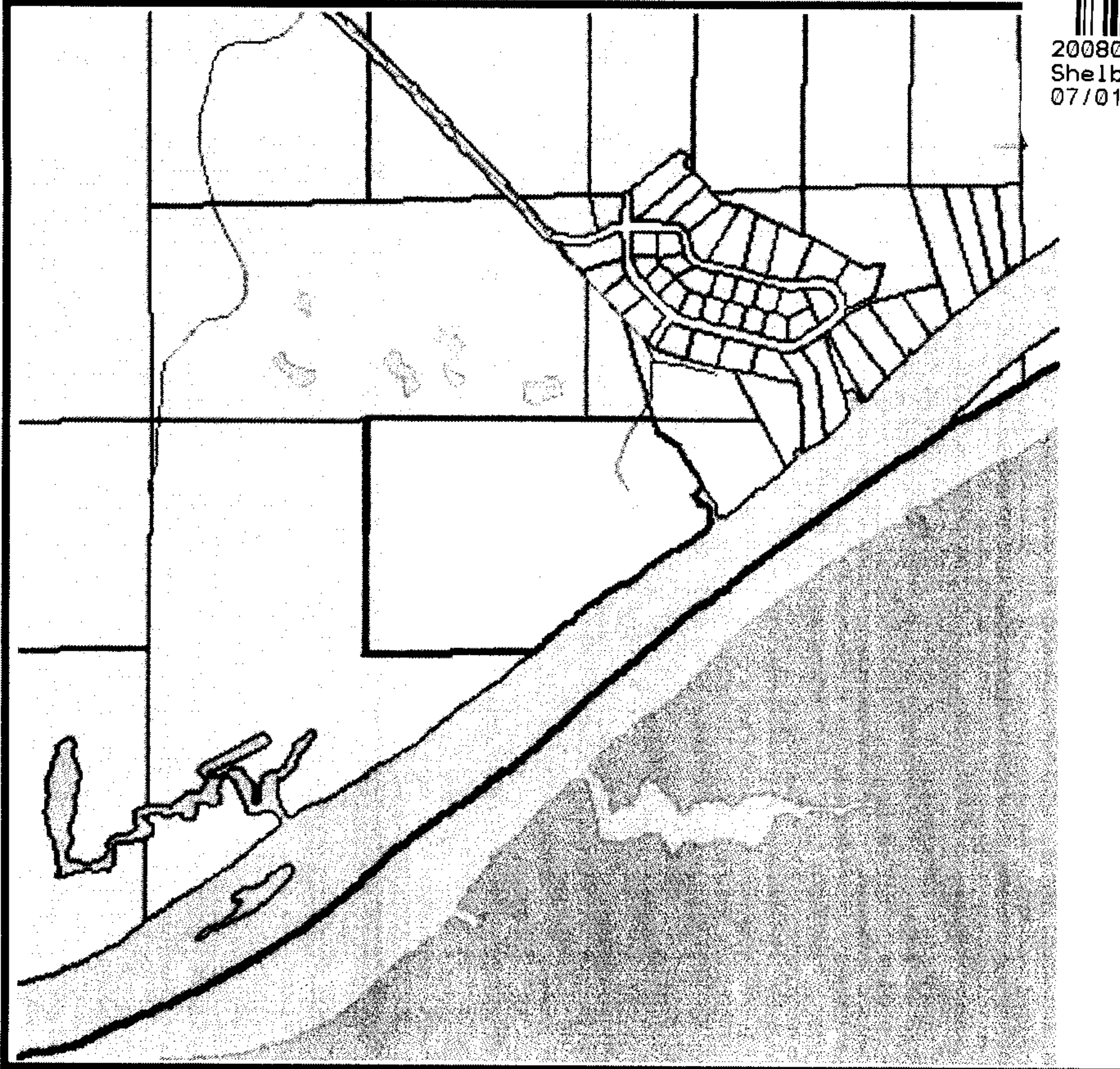
Property Information - 17 6 24 0 000 001.000

20080701000266740 5/5 \$23.00
Shelby Cnty Judge of Probate, AL
07/01/2008 09:24:09AM FILED/CERT

Owner Information

Name 1	Name2	Address 1	Address 2	City	State	Zip Code
HIGGINS WALTER R SR & JULIA D		1296 CHANCELLOR FERRY RD		HARPERSVILLE	AL	35078
Subdivision	Primary Lot	Secondary Lot	Block	Section	Township	Range
			000	24	20S	02E
Map Book	Map Page	Lot Dimension 1	Lot Dimension 2	Number of Acres	Square Feet	
0	0	0	0	54	2352240	

Description

BEG NW COR NE1/4 NW1/4 E ALG SEC LN 1715(S) SLY42.68 SE142.44 CONT SELY TO C OOSA RIVER MEANDER ALG RIVER WLY SLY & SELY & SWLY TO S LN NE1/4 NW1/4 W TO S W COR SD 1/4 1/4 N TO POB.

Document Information

Recorded Date	Recorded Number
19950821	19950002334300000