

This instrument prepared by:

Valerie J. Acocella
Alabama Power Company
P. O. Box 2641
Birmingham, Alabama 35291

[indicate President, General Partner, Member, etc.]

INDIVIDUAL NOTARIES

STATE OF ALABAMA }
COUNTY OF _____ }

I, the undersigned, a Notary Public, in and for said County in said State, hereby certify that _____
_____ whose name(s) is/are signed to the
foregoing instrument and who is/are known to me, acknowledged before me on this day that being informed of the contents
of the instrument, he/she/they executed the same voluntarily, on the day the same bears date.

Given under my hand and official seal this the _____ day of _____, 2005.

[SEAL] _____
Notary Public
My commission expires: _____

STATE OF ALABAMA }
COUNTY OF _____ }

I, the undersigned, a Notary Public, in and for said County in said State, hereby certify that _____
_____ whose name(s) is/are signed to the
foregoing instrument and who is/are known to me, acknowledged before me on this day that being informed of the contents
of the instrument, he/she/they executed the same voluntarily, on the day the same bears date.

Given under my hand and official seal this the _____ day of _____, _____.

[SEAL] _____
Notary Public
My commission expires: _____

TRUSTEE/CORPORATION/PARTNERSHIP/LLC NOTARY

STATE OF ALABAMA }
COUNTY OF _____ }

20060201000050990 2/3 \$17.50
Shelby Cnty Judge of Probate, AL
02/01/2006 09:44:20AM FILED/CERT

I, the undersigned, a Notary Public, in and for said County in said State, hereby certify that _____,
whose name as _____ of _____ a _____ [as
_____, is signed to the foregoing instrument, and who is
known to me, acknowledged before me on this day that being informed of the contents of the instrument, he/she, as such
_____ and with full authority, executed the same voluntarily for and as the act of said _____
_____ [acting in such capacity as aforesaid].

Given under my hand and official seal, this the _____ day of _____, _____.

[SEAL] _____
Notary Public
My commission expires: _____

=====

For Alabama Power Company Corporate Real Estate Department Use Only

All facilities on Grantor: ☒ Station to Station: STA 1+00 to STA 1+90

SKETCH OF PROPOSED WORK
SIMPLIFIED W.E.

Map Center UTM
1776882 12055516

Map Center LatLon
-86.553682 33.208845



Customer TIM SMITH		Location 850 HIGHWAY 5			Agreed Serv. Date		Estimate No. 61700-00-04805		
Region BHAM/SOUTH		Oper. Cntr. COLUMBIANA		Town/City COLUMBIANA		UserID ermbrash		Created: 10/20/2005	
County Shelby	Section 17	Township 21S	Range 01E	Add'l Info					
Acquisition Agent VALERIE ACOCELLA		Date R/W Assigned 10-21-2005		Date R/W Cleared 11-1-2005		Spatial Reference		LOC	Transformer Loading
Voltage	Phone Co	CATV Co	Accessible	Tree Crew	Rock Hole		R/W	City	County
Permits									

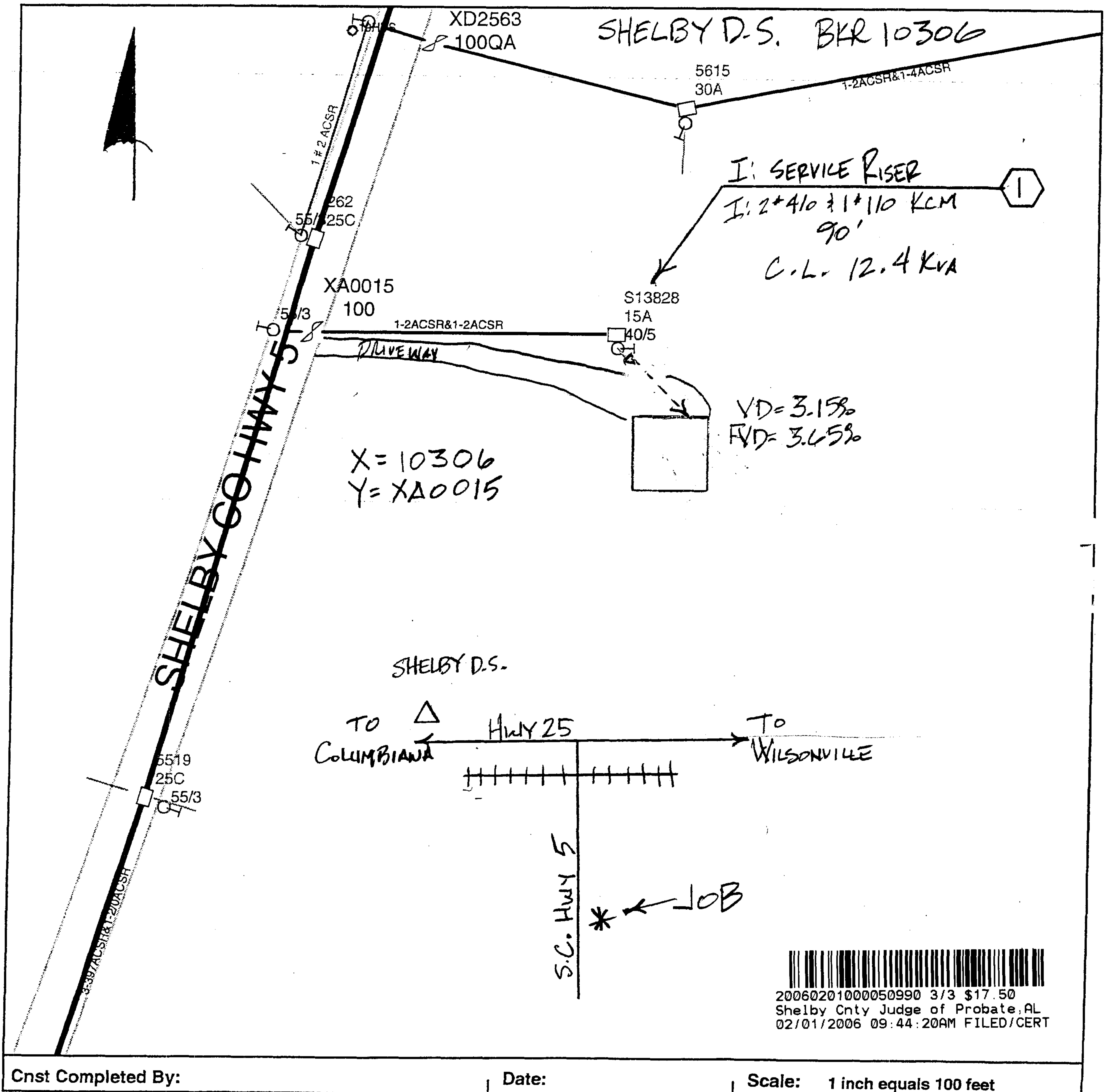

20060201000050990 3/3 \$17.50
 Shelby Cnty Judge of Probate, AL
 02/01/2006 09:44:20AM FILED/CERT

Cnst Completed By:

Date:

Scale: 1 inch equals 100 feet