

Michael A. Anderson, Esq.
SHAW~ANDERSON, LLC
2924 Crescent Avenue
Birmingham, AL 35209

(205) 871-9550



20050525000255660 1/3 \$17.00
Shelby Cnty Judge of Probate, AL
05/25/2005 04:10:08PM FILED/CERT

STATE OF ALABAMA)
SHELBY COUNTY)

NOTICE OF LIS PENDENS

TO THE HONORABLE JUDGE OF PROBATE OF JEFFERSON COUNTY, ALABAMA:

Comes now, Michael A. Anderson, and hereby gives notice to all persons concerned that Dorsey Clark Walker has a lien, right, interest, or claim in and to the following described real estate, said real estate being situated at Shelby County, Alabama, more particularly described as follows

7535 Highway 47, Shelby, AL 35143
6170 Valley Station Circle, Pelham, AL 35124

The nature of the lien, right, or claim sought to be enforced is as follows:

On May 24, 2005, pursuant to Walker v. Walker, Shelby County Circuit Court Case No.: DR-05-301.01, Hon. G. Dan Reeves entered an Ex Parte Temporary Restraining Order restraining both parties from disposing, transferring, giving away, spending, encumbering, or otherwise dissipating any assets, monies or property belonging to the parties, whether individually, or separately, except that the parties are allowed to spend a sufficient sum for their normal and customary day to day living expenses, a certified copy of which Order is attached hereto as Exhibit A.

Respectfully submitted,

Michael A. Anderson (AND062), Attorney for Plaintiff
SHAW~ANDERSON, LLC
2924 Crescent Avenue
Birmingham, AL 35209
(205) 871-9550

Notary Public
Mary P. Miles
Commission Expires 6-14-2008

CERTIFICATE OF PROBATE JUDGE

STATE OF ALABAMA)
SHELBY COUNTY)

The undersigned as Probate Judge of Jefferson County, Alabama, hereby certifies that the Lis Pendens contained herein was filed in this office for record on the _____ day of _____, 2005, at _____ o'clock ____ .m., and was duly recorded in Book _____ of Lis Pendens, Page _____.

Probate Judge

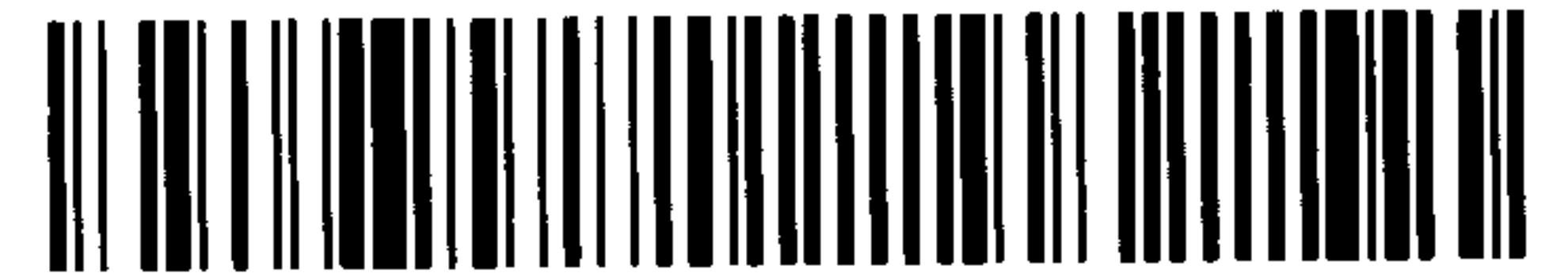

20050525000255660 2/3 \$17.00
Shelby Cnty Judge of Probate, AL
05/25/2005 04:10:08PM FILED/CERT

LEGAL DESCRIPTION EXHIBIT A

Commence at the Southwest corner of Section 10, Township 24 North, Range 15 East, thence run North 90° 00' 00" East a distance of 304.36 feet to a point; thence run North 35° 56' 08" West for a distance of 375.87 feet to a point; said point being the point of beginning; thence run South 49° 21' 33" West for a distance of 257.74 feet to a point; thence run North 44° 24' 51" West for a distance of 612.38 feet to a point; thence run North 44° 21' 56" West for a distance of 31.51 feet to a point; thence run North 61° 45' 18" East for a distance of 631.85 feet to a point; thence run South 40° 06' 16" East for a distance of 475.48 feet to a point; thence run South 49° 21' 34" West for a distance of 314.47 feet to a point; said point being the point of beginning. Situated in Shelby County, Alabama.

Inst # 2001-54754

12/13/2001-54754
03:08 PM CERTIFIED
SHELBY COUNTY JUDGE OF PROBATE

002 CH 14.30

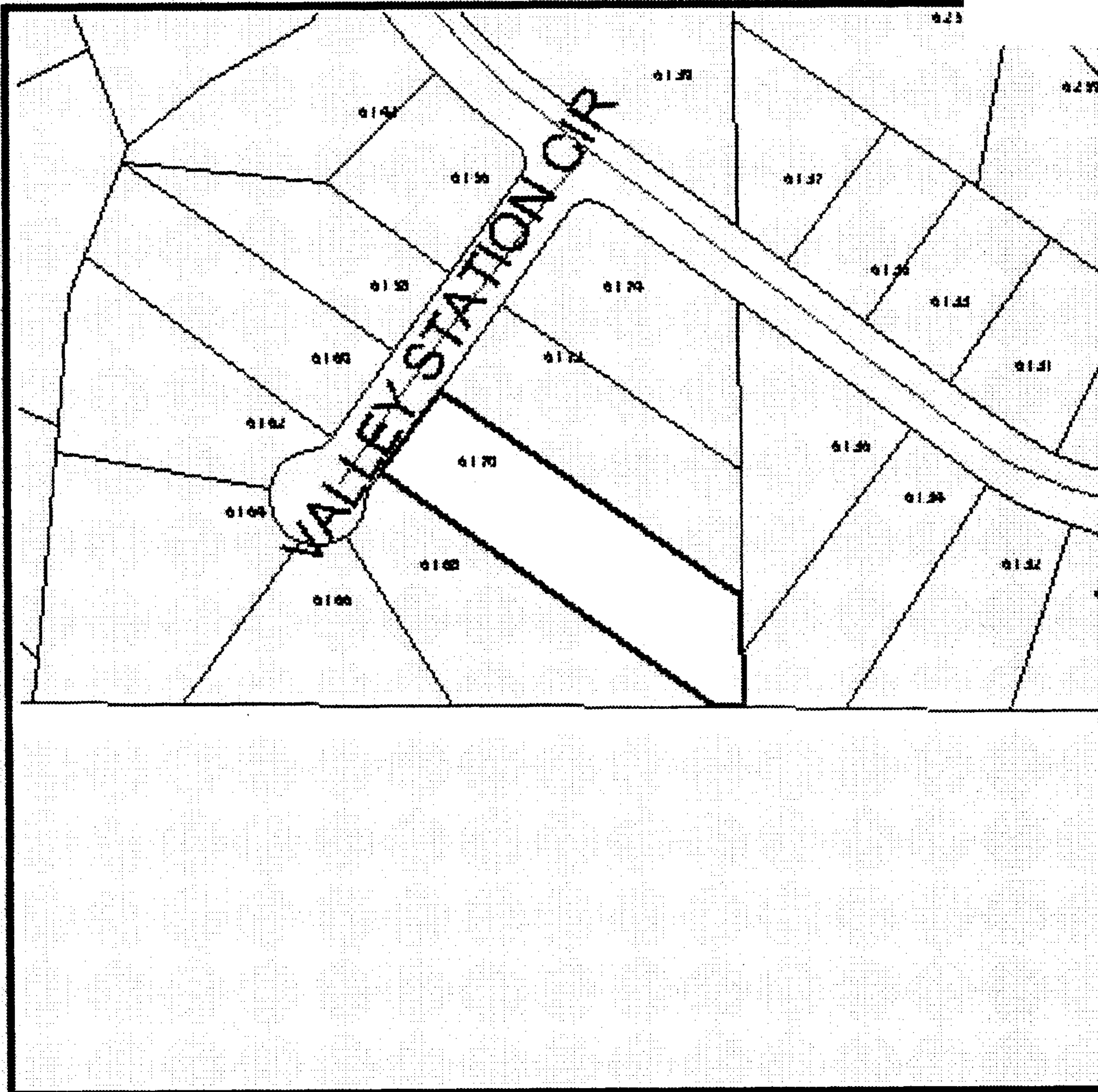

20050525000255660 3/3 \$17.00
Shelby Cnty Judge of Probate, AL
05/25/2005 04:10:08PM FILED/CERT

Property Information - 10 9 29 0 002 053.037**Owner Information**

Name 1	Name2	Address 1	Address 2	City	State	Zip Code
WALKER FLYNN		7535 HWY 47		SHELBY	AL	35143

Subdivision	Primary Lot	Secondary Lot	Block	Section	Township	Range
VALLEY STATION 1ST SECTOR	47		000	29	19S	02W

Map Book	Map Page	Lot Dimension 1	Lot Dimension 2	Number of Acres	Square Feet
7	47	100	388.53	0	0

Description**Document Information**

Recorded Date	Recorded Number
20021120	20020059843000000