

STATE OF ALABAMA
COUNTY OF SHELBY

W.E. #61700-08-0103-3

THIS SUPPLEMENTAL AGREEMENT made this 11th day of May, 2004 between Alabama Power Company, a corporation, hereinafter called the Power Company and Southern Natural Gas Company (successor to Southern Natural Gas Corporation), a corporation, hereinafter called the Gas Company;

WITNESSETH:

WHEREAS, there is in effect between the parties hereto, a certain agreement dated the 4th day of October, 1930, by which the Power Company has the right to construct, operate and maintain electric power lines over, under and across the rights of way and easements of the Gas Company; WHEREAS, the Power Company desires the right to construct, operate and maintain a power line over, under and across the rights of way of the Gas Company at the following locations:

At a point in the SE ¼ of NW 1/4, Section 25, Township 21 South, Range 3 West, Shelby County, Alabama and shown marked in yellow on Exhibit "A", sheets 1 & 2 of 2, attached hereto and made a part hereof.

NOW THEREFORE, in consideration of the premises and of their mutual covenants and agreements, the parties hereto have mutually covenanted and agreed as follows: The Gas Company hereby grants to the Power Company, insofar as the Gas Company has any right or title to make such grant, the right to construct, operate and maintain the power line crossing as shown on the print hereto attached and marked Exhibit "A" but subject, however, to all the terms and conditions of the aforesaid agreement dated October 4, 1930, and the parties agree that all and singular provisions of said agreement shall apply to the transmission and distribution line crossing herein described, the same manner and to the same extent as though such crossing had been included in the said agreement.

IN WITNESS WHEREOF, the parties hereto have caused this agreement to be executed the day and the year first above written.

(CORPORATE SEAL)

WITNESS: [Signature]

ALABAMA POWER COMPANY

By: [Signature]
Its Chief Technical Specialist

(CORPORATE SEAL)

WITNESS: [Signature]

SOUTHERN NATURAL GAS COMPANY

By: [Signature]
Lee D. Walker
Its Agent and Attorney-in-Fact

STATE OF ALABAMA

JEFFERSON COUNTY

I, John C. Gilmer, Jr., A Notary Public, in and ofr said County, in said State, hereby certify that Jerry D. Roberson, whose name as Chief Technical Specialist of Alabama Power Company, a corporation, is signed to the foregoing instrument, and who is known to me, acknowledged before me on this day that, being informed of the contents of this instrument, he, as such officer and with full authority, executed the same voluntarily for and as the act of said corporation.

Given under my hand and official seal, this, the 22 day of April, 2004.

My commission expires 7/2/2004

John C. Gilmer, Jr.
Notary Public - State at Large

STATE OF ALABAMA

JEFFERSON COUNTY

I, Tommie G. Hill, a Nötary Public, in and for said County, in said State, hereby certify that Lee D. Walker, whose name as Agent & Attorney-in-Fact of the Southern Natural Gas Company, a corporation, is signed to the foregoing instrument, and who is known to me, acknowledged before me on this day that, being informed of the contents of this instrument, he as such officer and with full authority, executed the same voluntarily for and as the act of said corporation.

Given under my hand and official seal, this the 11th day of May, 2004.

My commission expires 2/8/2006

Tommie G. Hill
Notary Public

SKETCH OF PROPOSED WORK — SIMPLIFIED W. E.

ALABAMA
POI
A SOUTHERN COMPANY

Customer <i>Tanglewood By the Creek</i>		Location <i>Co. 12</i>		Agreed Serv. Date		Estimate No. <i>61700-08-01033</i>	
Division <i>Birmingham</i>		District <i>Metro South</i>		Town <i>Alabaster</i>		Drawn by <i>Henderson</i>	
County <i>Shelby</i>		Section <i>25</i>		Township <i>21S</i>		Range <i>3W</i>	
Acquisition Agent		Date R/W Assigned		Date R/W Cleared		Map Reference	
						Add'l Info <i>In the SE 1/4 of NW 1/4</i>	
						LOC	Transformer Loadin



*Southern Natural Gas
Pipeline Crossing*

Sheet 1 of 2

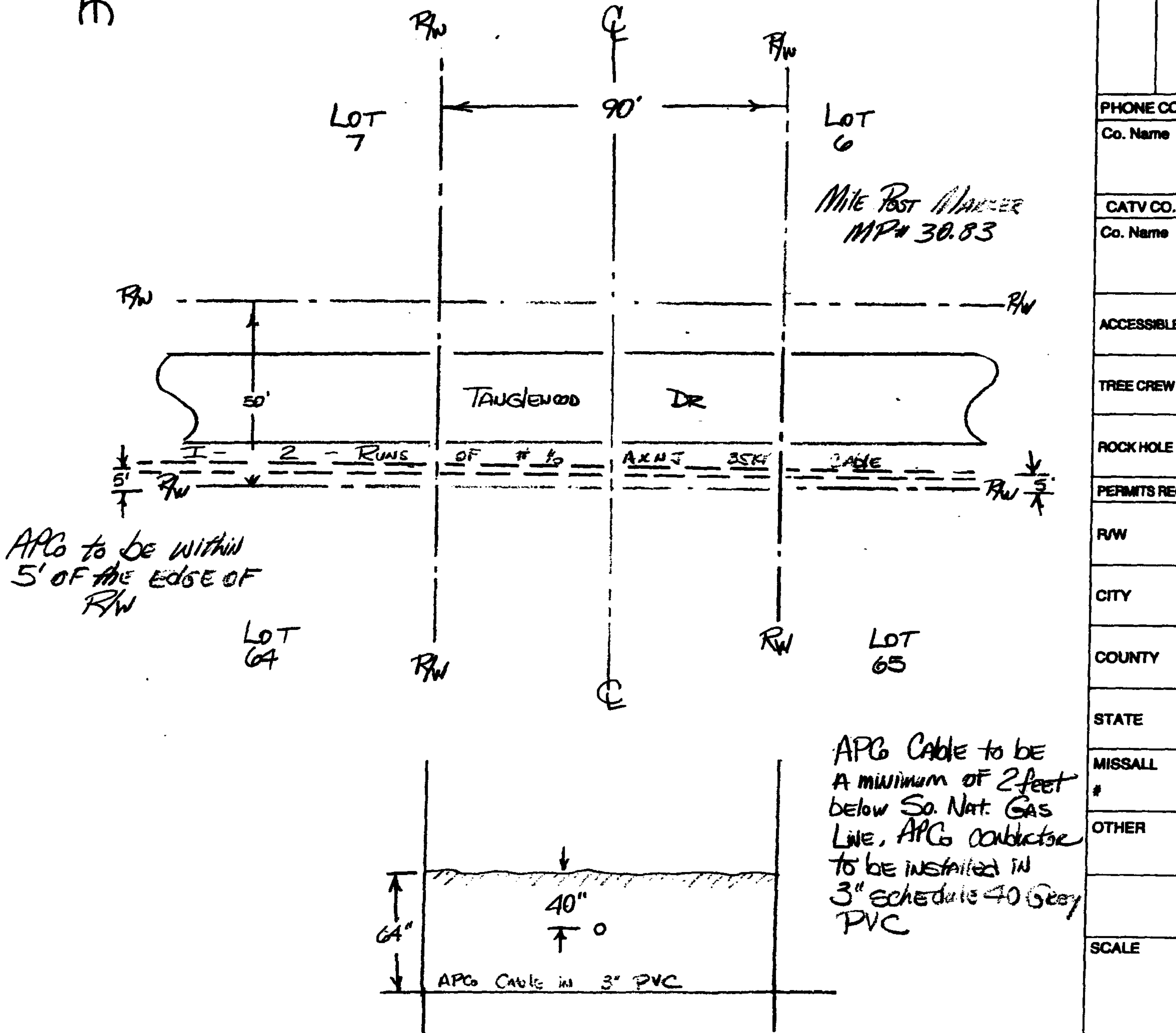

Voltage
Pri Se

PHONE CO.
Co. Name

CATV CO.
Co. Name

ACCESSIBLE

TREE CREW

ROCK HOLE

PERMITS REQ

R/W

CITY

COUNTY

STATE

MISSALL

OTHER

SCALE

Fl. Per Inch

Cnst. Completed By

Date

000005410 Pg 4/4 20.50
Shelby Cnty Judge of Probate, AL
09/10/2004 13:38:00 FILED/CERTIFIED

SECTIONALIZING SKETCH

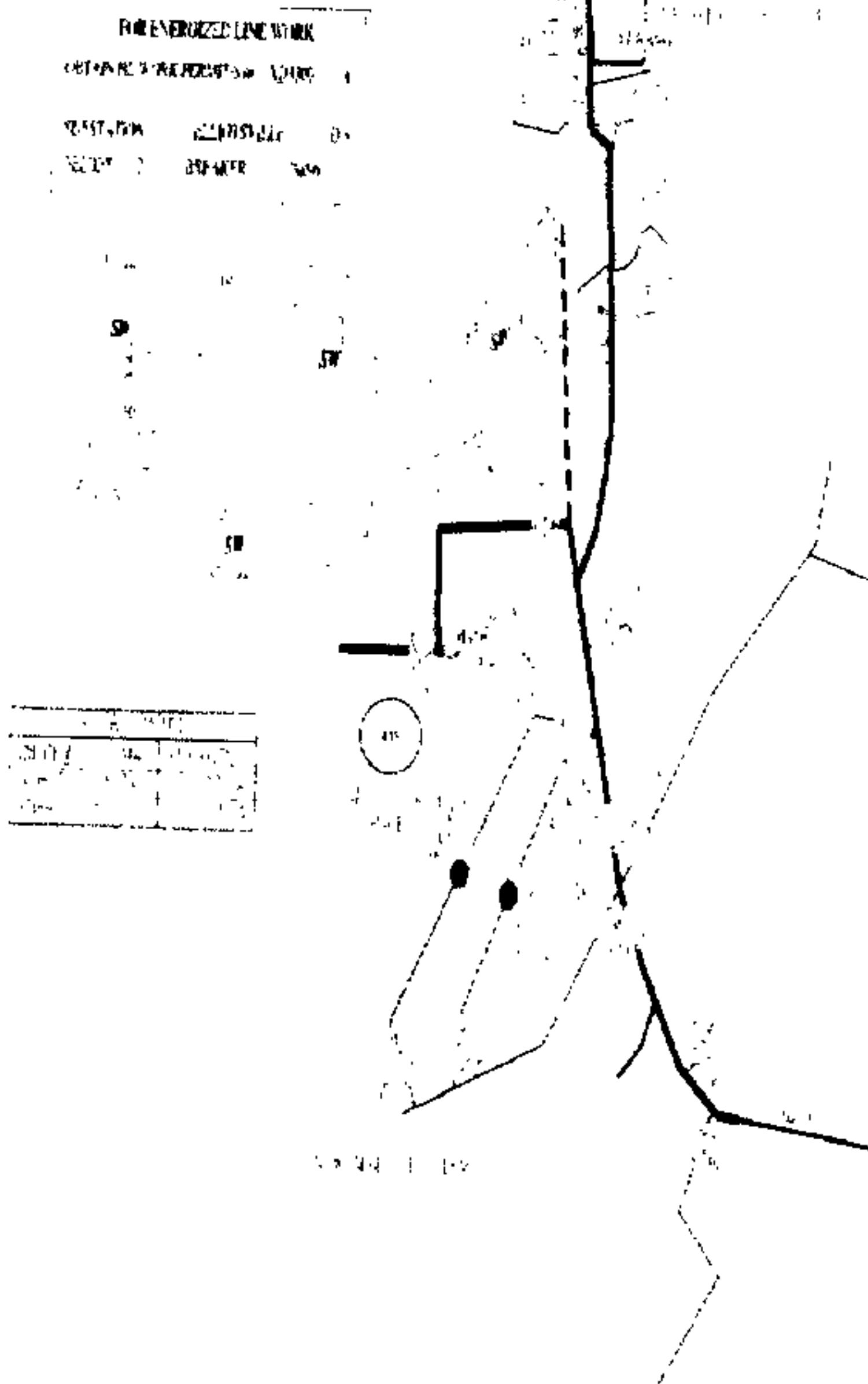

RECORDER'S MEMORANDUM
At the time of recordation, this instrument was found to be inadequate for the best photographic reproduction.

- 1. PROPER RECORDS MUST BE KEPT FOR 10 YEARS
- 2. CONFIDENTIAL DATA BEING HANDLED MUST BE PROTECTED AGAINST DISCLOSURE TO THE PUBLIC
- 3. PROPER DATA TO BE KEPT MUST BE IDENTIFIED AND PROTECTED AGAINST DISCLOSURE
- 4. ALL DATA MUST BE KEPT IN A SECURE AND ACCESSIBLE MANNER
- 5. ALL DATA MUST BE KEPT IN A SECURE AND ACCESSIBLE MANNER
- 6. ALL DATA MUST BE KEPT IN A SECURE AND ACCESSIBLE MANNER
- 7. ALL DATA MUST BE KEPT IN A SECURE AND ACCESSIBLE MANNER
- 8. ALL DATA MUST BE KEPT IN A SECURE AND ACCESSIBLE MANNER
- 9. ALL DATA MUST BE KEPT IN A SECURE AND ACCESSIBLE MANNER
- 10. ALL DATA MUST BE KEPT IN A SECURE AND ACCESSIBLE MANNER

MCIVER, ERNE MERVIN
BORN: 1907

ANY CONSTRUCTION FIELD CHANGES ARE SHOWN IN A

ALABAMA POWER

1. NAME
 2. DATE
 3. TIME