

#1800



20021119000577510 Pg 1/3 18.00
Shelby Cnty Judge of Probate, AL
11/19/2002 12:16:00 FILED/CERTIFIED

EASEMENT - POLE LINE, INDIVIDUAL

TO BE RECORDED: YES ☒ NO ☐

STATE OF ALABAMA }
COUNTY OF Shelby }
TAX ID # _____

W.E. No. 61700-00-0373-200
Parcel No. 70108204
Transformer No. _____

Larry D. Burchett
Alabama Power Company
P. O. Box 2641
Birmingham, Alabama 35291

KNOW ALL MEN BY THESE PRESENTS, That ☒ (We) Dennis Steve Mask and wife,
Julie N. Mask

as Grantor(s) (the "Grantor", whether one or more), for and in consideration of the sum of One and No/Dollars (\$1.00), and other good and valuable consideration, to said Grantor in hand paid by Alabama Power Company, a corporation, the receipt and sufficiency of which is hereby acknowledged, does for itself, its successors and assigns, grant to said Alabama Power Company, its successors and assigns (the "Company"), the right to construct, operate and maintain its lines of poles, wires and appliances necessary or useful in connection therewith, as located by the final location drawing heretofore made by said Company, for the transmission and distribution of electric power, with the right to attach guy wires and anchors thereto, upon, over, under and across the following described real property situated in Shelby County, Alabama (the "Property"), to wit:

A parcel of land in the SE 1/4 of the NE 1/4 of Section 34, Township
20 South, Range 1 West as is recorded in Deed Record 2000/6009 in the
office of the Judge of Probate of Shelby County, Alabama.

In the event it becomes necessary or desirable for said Company to move its lines of poles and appliances in connection with the construction or improvement of any public road or highway in proximity to its said power lines, the said Company is hereby granted the right to relocate its said lines of poles and appliances and, as to such relocated lines of poles and appliances, to exercise the rights granted above; provided, however, the said Company shall not relocate its said lines of poles and appliances on the Property at a distance greater than ten feet (10') outside the boundary of the right of way of any such public road or highway as established or re-established from time to time.

Together with all rights and privileges necessary or convenient for the full enjoyment or use thereof, including the right of ingress and egress to and from said lines; the right in the future to install and utilize intermediate poles in line; and also the right to clear a strip of land extending fifteen feet (15') to either side of the center of the line of poles and keep it cleared of all trees and undergrowth and all structures, obstructions or obstacles of whatever character; and the right to trim and cut and keep trimmed and cut all dead, weak, leaning or dangerous trees or limbs outside of the said thirty foot (30') strip which, in the sole opinion of said Company, might endanger, interfere with or fall upon the poles, lines, or other appliances of Company.

TO HAVE AND TO HOLD the same to the said Company, its successors and assigns, forever.

IN WITNESS WHEREOF, We have hereunto set our hand(s) and seal(s), on this the 5th day of September 2002.

WITNESS: [Signature]

WITNESS: [Signature]

WITNESS: [Signature]

WITNESS: [Signature]

[Signature] (Seal)

[Signature] (Seal)

[Signature] (Seal)

[Signature] (Seal)

All facilities on Grantor: _____

Station to Station: _____

Stall 2 to Stall 3 too (Northside)
Guy 5 on Stall 2, 3

STATE OF ALABAMA }

COUNTY OF _____ }

I, the undersigned, a Notary Public, in and for said County in said State, hereby certify that _____
_____ whose name(s) _____ signed to the foregoing instrument and who _____
known to me, acknowledged before me on this day that being informed of the contents of the instrument, _____ executed the same voluntarily,
on the day the same bears date.

Given under my hand and official seal this the _____ day of _____, _____.

[SEAL]

Notary Public

My commission expires: _____

STATE OF ALABAMA }

COUNTY OF _____ }

I, the undersigned, a Notary Public, in and for said County in said State, hereby certify that _____
_____ whose name(s) _____ signed to the foregoing instrument and who _____
known to me, acknowledged before me on this day that being informed of the contents of the instrument, _____ executed the same voluntarily,
on the day the same bears date.

Given under my hand and official seal this the _____ day of _____, _____.

[SEAL]

Notary Public

My commission expires: _____

STATE OF ALABAMA }

COUNTY OF _____ }

I, the undersigned, a Notary Public, in and for said County in said State, hereby certify that _____
_____ whose name(s) _____ signed to the foregoing instrument and who _____
known to me, acknowledged before me on this day that being informed of the contents of the instrument, _____ executed the same voluntarily,
on the day the same bears date.

Given under my hand and official seal this the _____ day of _____, _____.

[SEAL]

Notary Public

My commission expires: _____

SECTIONALIZING SKETCH

LOCATION SKETCH

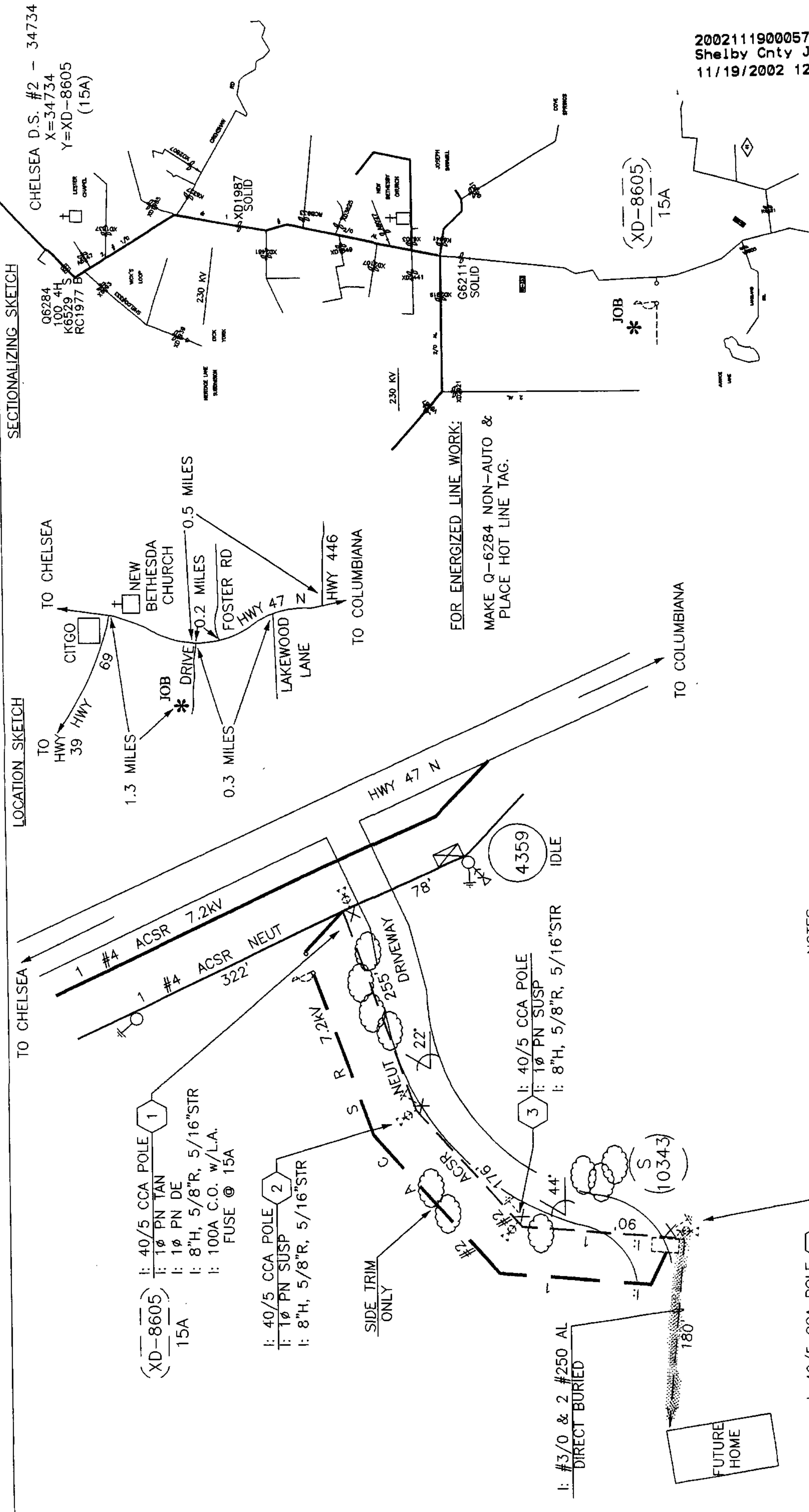

NOTES:

1. TREE CREW REQUIRED - 1/2 DAY. CUSTOMER TO BE NOTIFIED BEFORE TREES ARE CUT. CUSTOMER WORKS FOR SOUTHERN COMPANY SERVICES. HIS LINC PHONE NUMBER IS 8-350-3826.
2. CUSTOMER TO PAY \$510.00 FOR UG SERVICE.
3. APCO TO PERFORM ALL WORK.

AUTOMATED DRAWING: ALABAMA P.
 JOB: POWER DELIVE
 DETAIL: JOHN CHITW
 MAP REF: SEC-34SEP-20SR-1W
 DRAWN: JLT ENGR BOB DUKE DATE 09/03/02
 APPROVED: DATE
 SHEET 1 OF 1 SHEET
 SUPERSEDES:

