

STATE OF ALABAMA     )  
COUNTY OF SHELBY    )

**RIGHT OF WAY EASEMENT**

In consideration of the sum of SIX THOUSAND DOLLARS AND No/100 CENTS (\$6,000.00), and other good and valuable consideration, the adequacy and receipt of which is hereby acknowledged from **BELLSOUTH TELECOMMUNICATIONS, INC.**, a Georgia corporation, (hereinafter referred to as "BST"), **MARVIN TURNER**, (hereinafter referred to as Grantor), as owner of the premises as described below, does hereby grant to BST, its licenses, agents, successors, assigns, and allied and associated companies, a right of way easement to construct, operate, maintain, add or remove such lines or systems of communications or related services as BST may require, consisting of:

- (1) poles, guys, anchors, aerial cables and wires;
- (2) buried cables and wires, cable terminals, markers, splicing boxes and pedestals;
- (3) conduits, manholes, markers, underground cables and wires;
- (4) and other amplifiers, boxes, appurtenances or devices,

upon, over, and under a strip of land ten (10) feet wide parcel of land situated in the S.W. 1/4 of the N.E. 1/4 of Section 16, Township 22 South, Range 2 West, said parcel of land lying 5 feet on either side of its centerline, said centerline being more particularly described as follows:

Commence at an iron pin found at the S.W. corner of the S.W. 1/4 of the N.E. 1/4 of said Section 16; thence proceed Northerly along the West line of said S.W. 1/4 of N.E. 1/4 for 668.52' to an iron pin found at the N.W. corner of the N.W. 1/4 of the S.W. 1/4 of the N.E. 1/4 of said Section 16; thence, turn a deflection angle right of 89°14'42" and proceed Easterly along the South line of said N.W. 1/4 of S.W. 1/4 of N.E. 1/4 for 431.03 feet to a point located under an existing overhead telephone cable, said point also being the POINT OF BEGINNING of said centerline; thence turn a deflection angle left of 87°32'19" and proceed Northerly along and with said overhead telephone cable for 44.55 feet to a point at an existing telephone pole; thence turn a deflection angle right of 00°46'37" and continue Northerly along and with said overhead telephone cable for 117.39 feet to a point at an existing telephone pole; thence turn a deflection angle right of 00°20'40" and continue Northerly along and with said overhead telephone cable for 258.11 feet to a point at an existing telephone pole; thence turn a deflection angle left of 00°06'47" and continue Northerly along and with said overhead telephone cable for 48.52 feet to the end of said centerline.

02/20/1996-05501  
03:58 PM CERTIFIED  
SHELBY COUNTY JUDGE OF PROBATE  
003 SNA 19.50

The following rights are also granted: to allow any other person or company authorized by BST, to attach wires or lay cable or conduit within the right of way for communications or electric power transmission or distribution; ingress and egress to said premises at all times; to clear the land and keep it cleared of all trees, undergrowth or other obstructions within the easement area; to trim and cut and keep trimmed and cut all dead, weak, leaning or dangerous trees or limbs outside of the easement area which might interfere with or fall upon the lines or systems of communications or power transmission or distribution. A February 8, 1996, survey prepared by Daviel K. Capps, providing a description of easement is hereto attached and made a part of this right of way easement.

The receipt of SIX THOUSAND DOLLARS (\$6,000.00) is hereby acknowledged by Marvin Turner. To have and to hold the above granted easement unto BellSouth Telecommunications, Inc., its successors and assigns forever.

IN WITNESS WHEREOF, Marvin Turner has signed and sealed this document and caused this instrument to be executed on this the 16 day of FEB., 1996.

Marvin Turner (L.S.)  
Marvin Turner

State of Alabama   )  
County of Shelby   )

Sworn to and subscribed before me a Notary Public, this the 16 day of FEB, 1996.

Frank W. H.  
NOTARY PUBLIC

(seal)

My Commission Expires: 9-9-98

THE INTENT OF THIS SURVEY IS TO DEFINE A 10 FEET WIDE EASEMENT ACROSS THE ONLY PROPERTY OWNED BY MARVIN TURNER LOCATED IN THE N.W. 1/4 OF THE S.W. 1/4 OF THE N.E. 1/4, SECTION 16, TOWNSHIP 22 SOUTH, RANGE 2 WEST, SHELBY COUNTY, ALABAMA.

SURVEYOR DOES NOT CERTIFY AS TO TITLE OR OWNERSHIP OF PROPERTIES SHOWN ON THIS SURVEY.

U.S. HWY. #31

IRON PIN FOUND  
N.E. COR. OF  
S.W. 1/4 OF  
N.E. 1/4 OF  
T-22-S, R-2-W

IRON PIN FOUND  
S.W. COR. OF  
S.W. 1/4 OF  
N.E. 1/4 OF  
T-22-S, R-2-W

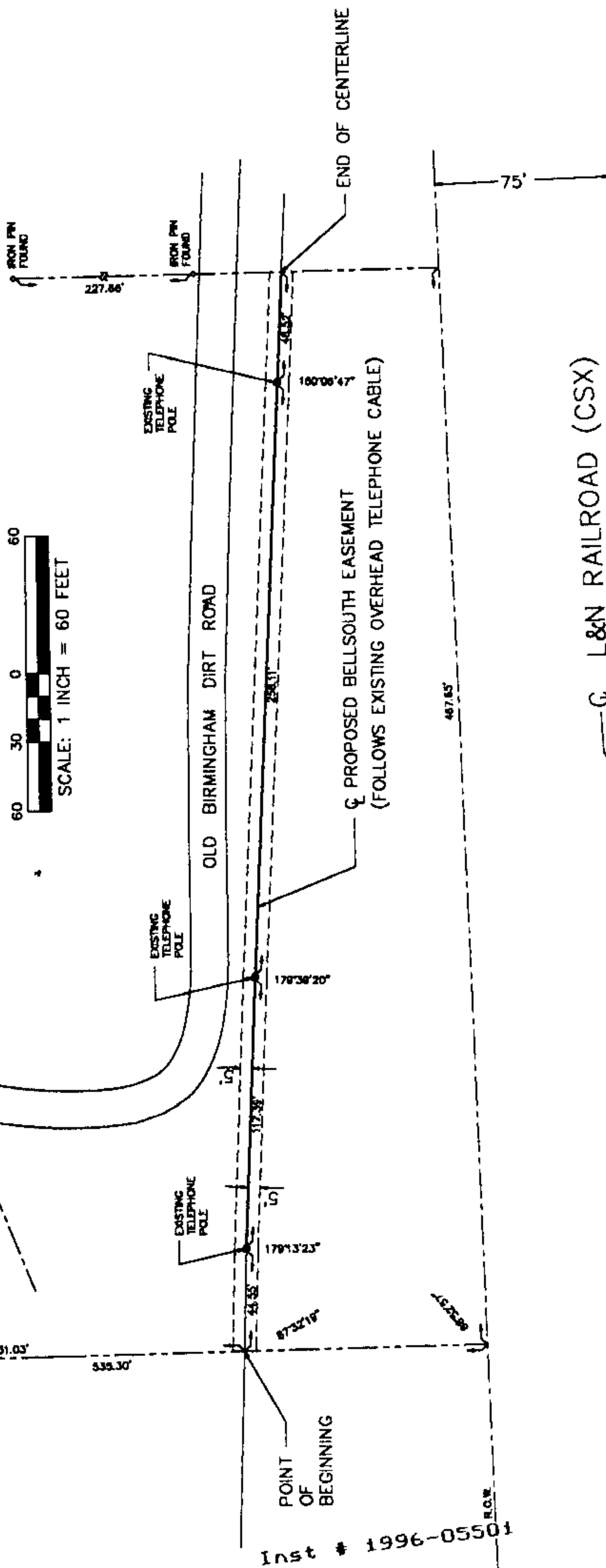
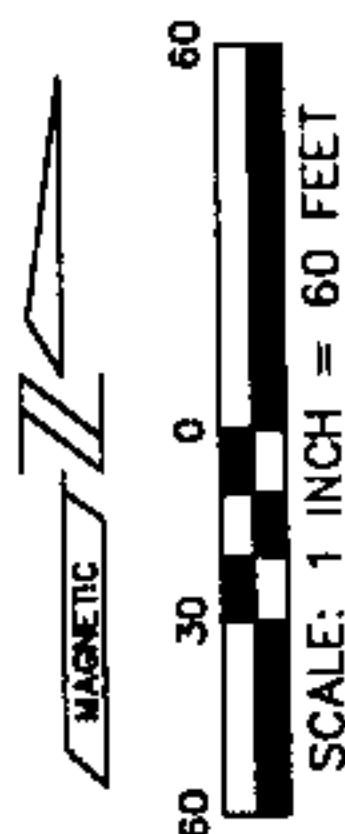

02/20/1996-05501  
03:58 PM CERTIFIED  
SHELBY COUNTY JUDGE OF PROBATE  
003 SWA 19.50

PREPARED BY:  
MCCOLLERS-CAPPS & ASSOCIATES, INC.  
85 BAGBY DRIVE, SUITE 108  
BIRMINGHAM, ALABAMA 35209  
PH. (205) 941-1519  
JOB #96009  
FEBRUARY 8, 1996