

COUNTY OF SHELBY

This Indenture made this 23rd day of May, 1995, between
Margaretta Jefferson - being only surviving heir of Susie Garner
403 10th Ave. West
Birmingham, AL 35204

of the State of Alabama, and County of Shelby, hereinafter called
First Party, and Renn & Johnson, LLC

hereinafter called Second Party.

WITNESSETH, that First Party, for and in consideration of the sum of \$18,000.00
(EIGHTEEN THOUSAND DOLLARS AND NO CENTS)

_____ Dollars, in hand paid at and before the sealing and delivery of these presents, the receipt whereof is hereby acknowledged, does by these presents grant, bargain, sell, convey, and confirm unto Second Party all of the following described property, rights and privileges:

All of the following described timber and trees, including saplings and tops suitable for pulpwood purposes, to-wit:

ALL merchantable timber

The above described timber and trees are standing, growing, or fallen on the following described land, to wit:

W $\frac{1}{2}$ of NE $\frac{1}{4}$, Sec 2 T22S, R1W
NW $\frac{1}{4}$ of SE $\frac{1}{4}$, Sec 2 T22S, R1W
All being in Shelby County, AL

SEE ATTACHED MAP

Inst # 1995-14692

06/06/1995-14692
12:04 PM CERTIFIED
SHELBY COUNTY JUDGE OF PROBATE
003 SNA 31.50

Also the right of ingress and egress over said lands and any adjacent lands of First Party for the purpose of cutting and removing said trees and timber, which rights may also be exercised by Second Party's independent contractors, their servants, agents, and workmen, in, through, over, and upon the said lands; also the privilege of adequate roads and rights of way as may be needed and the right to use and improve existing roads upon the lands described herein and, where necessary, to construct haul roads and to obtain borrow material for such purpose close to the area where such material is needed; also the right to go upon said lands with men, cars, trucks, and other vehicles for the purpose of cutting, harvesting, logging, and sawing the trees and timber and removing therefrom the trees and timber; to stack and pile lumber and logs thereon; and all other logging rights and privileges usually given and not hereinabove mentioned.

Renn + Johnson, LLC
PO Box 547
Centreville AL, 35042

The term of this contract shall be May 23, 1996 from the date hereof and Second Party is to have the above granted property, rights and privileges for said length of time.

And it is expressly agreed between the parties hereto that this conveyance and sale embraces not only the trees and timber, including pulpwood saplings and trees within the description herein contained at the date hereof but all that may grow to the measure of such description during the term of this contract.

TO HAVE AND TO HOLD the said bargained trees, timber, and pulpwood rights to Second Party as above set out; and the title to the said property and the privileges the said First Party will warrant and defend against the lawful claims of all persons whomsoever. SELLER WILL GUARANTEE TITLE TO THE TREES SOLD UNDER THIS CONTR/ AND DEFEND SUCH TITLE AGAINST ALL CLAIMS AT THE EXPENSE OF THE SELLER.

All agreements, covenants, duties, rights, privileges, and powers herein made, imposed, granted, or mentioned, which are binding upon or applicable to either or both of the parties hereto, shall also be binding upon and applicable to the heirs, legal representatives, successors and assigns of such party or parties.

IN WITNESS WHEREOF, First Party has signed, sealed, and delivered these presents, the day and year first above written.

(L. S.) S.S.# [REDACTED] Margaretta Jefferson (L. S.)

WITNESS: [Signature]
STATE OF ALABAMA
COUNTY }

I, _____, a Notary Public in and for said County, in said State, hereby certify that _____ whose name _____ signed to the foregoing conveyance, and who _____ known to me, acknowledged before me on this day, that, being informed of the contents of the conveyance _____ executed the same voluntarily on the day the same bears date.

Given under my hand and official seal this _____ day of _____ A.D., 19 _____.

Notary Public

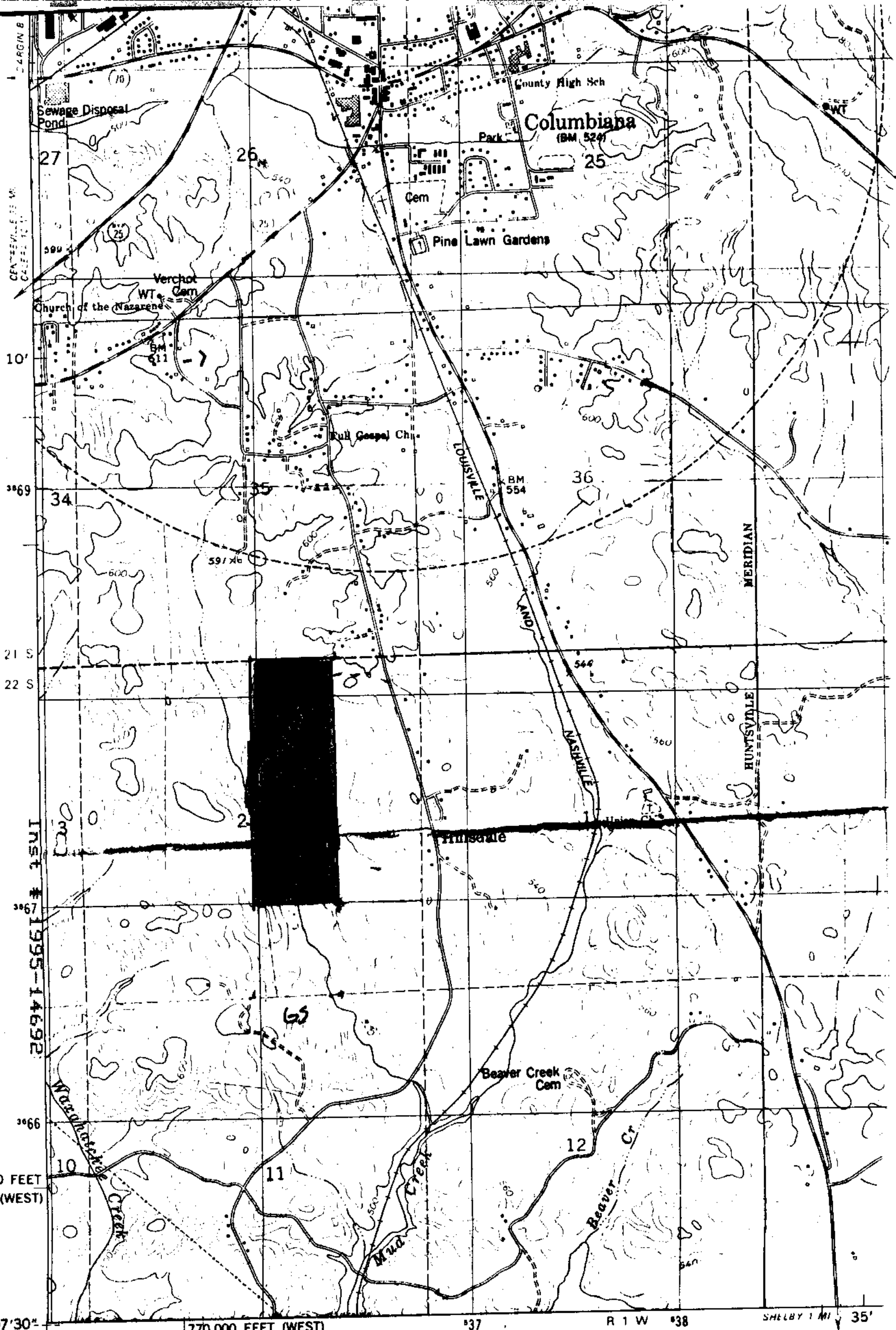

COLUMBIA

10'

3669

T 21 S

T 22 S

Inst #1995-14692

3667

3666

10

33°07'30"

86°37'30"

10ZANI
50 11 SW

1770 000 FEET (WEST)

37

R 1 W

38

SHELBY 1 MI

35'

Mapped, edited, and published by the Geological Survey
Control by USGS and NOS/NOAA

SALE AREA



06/06/1995-14692
12:04 PM CERTIFIED
SHELBY COUNTY JUDGE OF PROBATE
003 SNA 31.50