

EASEMENT — OVERHEAD AND UNDERGROUND

W. E. No. 64600000682-200

STATE OF ALABAMA

Parcel No. _____

COUNTY OF

ShelbySta # 1+00 to Sta # 1+125
(underground)

KNOW ALL MEN BY THESE PRESENTS, That

W. T. Edwards III; A married manand sole owner

as grantor(s), (the "Grantor", whether one or more) for and in consideration of One and No/100 Dollars (\$1.00), and other good and valuable consideration, to Grantor in hand paid by Alabama Power Company (the "Company"), a corporation, the receipt of which is hereby acknowledged, do hereby grant to Company, its successors and assigns, the right to construct, install, operate and maintain, and the right to permit other corporations and persons to construct, install, operate and maintain, along a route to be selected by the grantee, (generally shown hatched on the attached drawing) its successors or assigns, all poles, wires, conduits, cables, translosures and other appliances and facilities useful or necessary in connection therewith, for the overhead and underground transmission and distribution of electric power and for overhead and underground communication service upon,

over, under and across the following described real property situated in Shelby

County, Alabama (the "Property"), to wit:

Lot # 7 of Windy Oaks Phase II as is

recorded in Map Book 15 at Page 112 in the office of the Judge of Probate
of Shelby County, Alabama. Located in the N¹/₄ of the N¹/₂ and the N¹/₂ of the
N¹/₄ of Section 22, Township 21 South, Range 3 West.

Together with all the rights and privileges necessary or convenient for the full enjoyment or use thereof, including the right of ingress and egress to and from said facilities and the right to excavate for installation, replacement, repair and removal thereof; and also the right to cut and keep clear any and all obstructions or obstacles of whatever character on, under and above said facilities.

TO HAVE AND TO HOLD such easement to Company, its successors and assigns, forever.

IN WITNESS WHEREOF, I have set My hand(s) and seal(s) this the 14th day of October, 1992.

WITNESS:

Marion D. Glass

GRANTOR(S):

W. T. Edwards, III

(SEAL)

(SEAL)

(SEAL)

(SEAL)

This instrument prepared in
Birmingham Div. Real Estate
Dept. of Alabama Power Co.
Birmingham, AL

By Sara Parks

GRANTEE'S ADDRESS
ALABAMA POWER CO.
P.O. BOX 2641
BIRMINGHAM, AL 35291-1980

IN WITNESS WHEREOF, the said Grantor, has caused this instrument to be executed by its President,
_____, who is authorized to execute this conveyance, has hereto set its
signature and seal on this the _____ day of _____ 14th 1993-15118

ATTEST:

By: _____

Its: Secretary.

05/25/1993-15118
03:27 PM CERTIFIED
SHELBY COUNTY JUDGE OF PROBATE
002 KCD 9.50

SKETCH OF PROPOSED WORK — SIMPLIFIED W. E.

Customer W. T. EDWARDS	Location 1294 BUTLER RD.	Agreed Serv. Date 10-30-92	Estimate No. 64600 00 0682-2
Division WESTERN	District MONTEVALLO	Town ALABASTER	Drawn by GLASS
County SHELBY	Section 22	Township 21S	Range 3W
Acquisition Agent LS	Date R/W Assigned 10-6-92	Date R/W Cleared 10-16-92	Map Reference C-60275-9

LOC X	Transformer Loading 39886
Y	6521
Z	Q

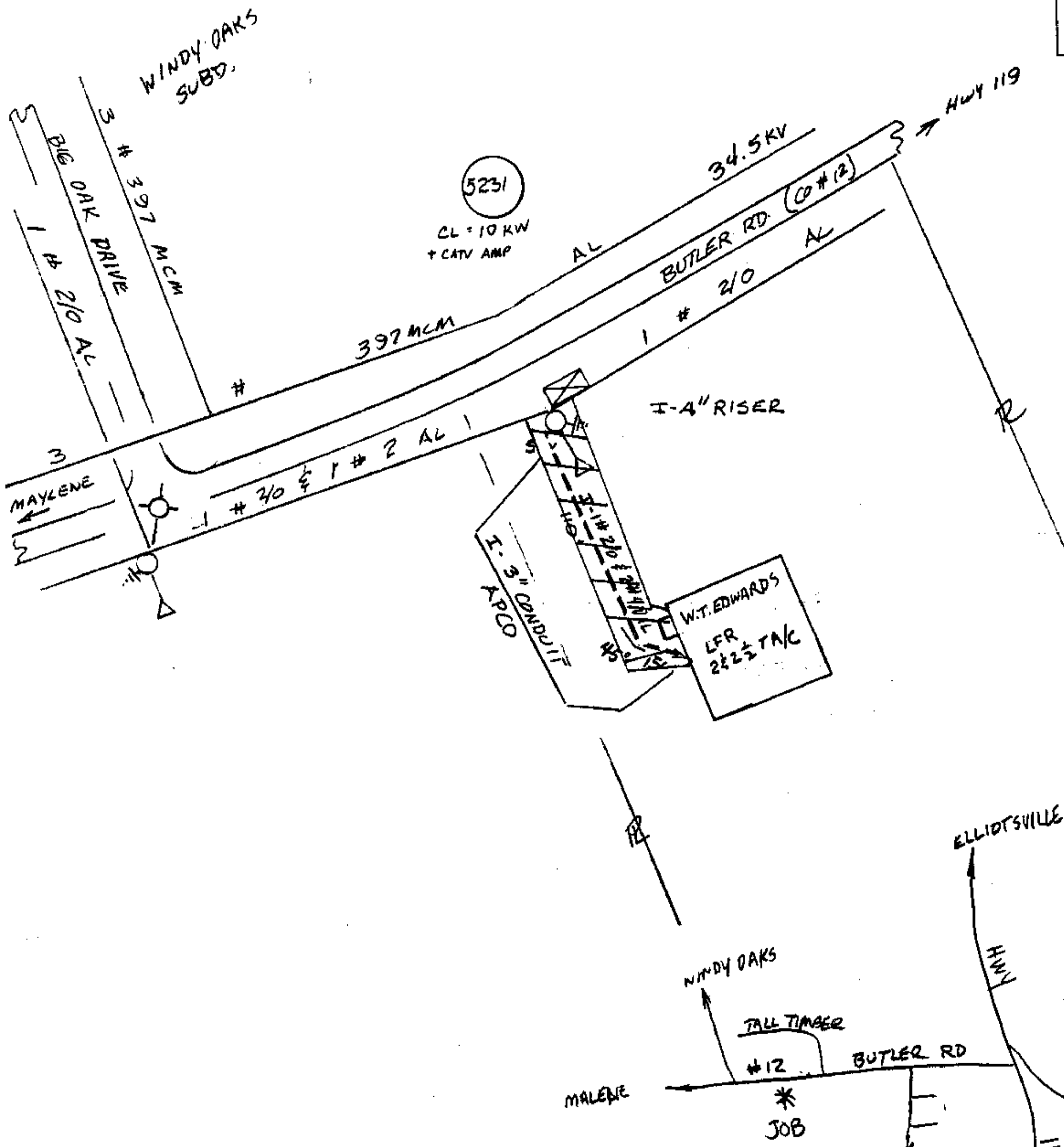

Voltage	
Pri	Sec.
PHONE CO.	
Co. Name	
CATV CO.	
Co. Name	
ACCESSIBLE	
TREE CREW N	
ROCK HOLE	
PERMITS REQ'D	
R/W	
CITY	
COUNTY	
STATE	
MISSALL # N/A	
OTHER	
SCALE	
Ft. Per Inch	

Inst # 1993-15118
 05/25/1993-15118
 03:27 PM CERTIFIED
 SHELBY COUNTY JUDGE OF PROBATE
 002 MCD 9.50

Cnst. Completed By	Date
--------------------	------