

EASEMENT - POLE LINE, INDIVIDUAL

W. E. 62500-00-0053 200

STATE OF ALABAMA,

Parcel _____

COUNTY OF shelby

Sta. 1+60 to Sta. 2+120

I (We) John L. Gay and wife, Loudell Walker Gay as Seller

_____, as grantor(s) (the "Grantor" whether one or more) for and in consideration of One and No/100 Dollars (\$1.00), and other good and valuable consideration, to said Grantor in hand paid by Alabama Power Company, a corporation (the "Company"), the receipt of which is hereby acknowledged, do hereby grant to Company, its successors and assigns, the right to construct, operate and maintain its lines of poles and appliances necessary in connection therewith, as located by the final location drawing heretofore made by said Company, for the transmission of electric power with the right to set poles in line, to set in the future intermediate poles in line, to attach guy wires and anchors thereto, and to string thereon from time to time electric power and communication wires and the right to permit other corporations and persons to attach telephone and other wires to said poles upon,

over, under and across the following described lands situated in Shelby County, Alabama (the "Property"), to wit:

Commence at the N.E. Corner of the SE 1/4 of the SE 1/4 of Section 24, Tp. 18 South, Range 1 East and run South 42°13'35" West for 617.57 feet to the Point of Beginning; thence continue along last described course 250.00 feet to the north R.O.W. line of Shelby County Road No. 45; thence turn 75°08'33" right and run along said R.O.W. line 180.00 feet; thence turn 104°51'27" right and run 250.00 feet; thence turn 75°08'33" right and run 180.00 feet to the P.O.B. containing 1.00 acres more or less.

Subject to any rights-of-ways, easements, reservations or restrictions of public record.

Inst # 1992-08419
05/15/1992-08419
02:17 PM CERTIFIED
SHELBY COUNTY JUDGE OF PROBATE
003 MCD 12:00

This instrument prepared in the Corporate Real Estate Dept. of Alabama Power Co. Birmingham, Ala.

By G W SMITH

It is the intent it becomes necessary or desirable for Company to move its lines of poles and appliances in connection with the construction or improvement of any public road or highway in proximity to its power lines, Company is hereby granted the right to relocate its lines of poles and appliances on the Property, provided, however, Company shall relocate its lines of poles at a distance not greater than ten feet (10') outside the boundary of the right of way of any such public road or highway as established or re-established from time to time.

Together with all the rights and privileges necessary or convenient for the full enjoyment or use thereof, including the right of ingress and egress to and from said lines; and also the right to clear a strip extending fifteen feet (15') to either side of the center line of the lines of poles and keep it cleared of all trees, undergrowth or other obstructions; to trim and cut and keep trimmed and cut all dead, weak, leaning or dangerous trees or limbs outside of the thirty foot (30') strip which, in the sole opinion of Company, might endanger, interfere with or fall upon the poles, lines, or other appliances of said Company.

TO HAVE AND TO HOLD the same to Company, its successors and assigns, forever.

IN WITNESS WHEREOF, I have hereunto set my hand(s) and seal(s), on this the 26 day of February, 1992.

WITNESS: _____

John L. Gay (Seal)

WITNESS: _____

Loudell Walker Gay (Seal)

WITNESS: _____

GRANTEE'S ADDRESS
ALABAMA POWER CO.
P.O. BOX 2641
BIRMINGHAM, AL 35291
ATT: CORP. REAL ESTATE

Loudell Gay is infirm and unable to sign permit (Seal)

STATE OF ALABAMA

COUNTY OF Shelby }

I, the undersigned, a Notary Public in and for said County in said State, do hereby certify that John L. Gay

whose name(s) is signed to the foregoing instrument

and who is known to me, acknowledged before me on this day that being informed of the contents of the said instrument, has executed the same voluntarily, on the day the same bears date.

Given under my hand and official seal, this the 26th day of February, 19 92.

Jaime J. Blackerby
Notary Public

My commission expires: January 13, 1992

[SEAL]

STATE OF ALABAMA

COUNTY OF _____ }

I, the undersigned, a Notary Public in and for said County in said State, do hereby certify that _____

whose name(s) _____ signed to the foregoing instrument

and who _____ known to me, acknowledged before me on this day that being informed of the contents of the said instrument, _____ executed the same voluntarily, on the day the same bears date.

Given under my hand and official seal, this the _____ day of _____, 19 _____.

Notary Public

My commission expires: _____

[SEAL]

SKETCH OF PROPOSED WORK — SIMPLIFIED W. E.

REQ # 2110
CUST # 112

Alabama Power 

Customer LORI MCGUIRE		Location CO RD 45		Agreed Serv. Date 3-13-92		Estimate No. 62500-00-0053 200	
Division EASTERN		District TALLADEGA		Town STERRETT		Drawn by JORDAN	
County SHELBY		Section 24		Township 18S		Range 1E	
Acquisition Agent SMITH		Date R/W Assigned 2/27/92		Date R/W Cleared 3-4-92		Map Reference C-65735-50	
				Add'l Info CUST HAS R/W FORMS		LOC	
						Transformer Loading	

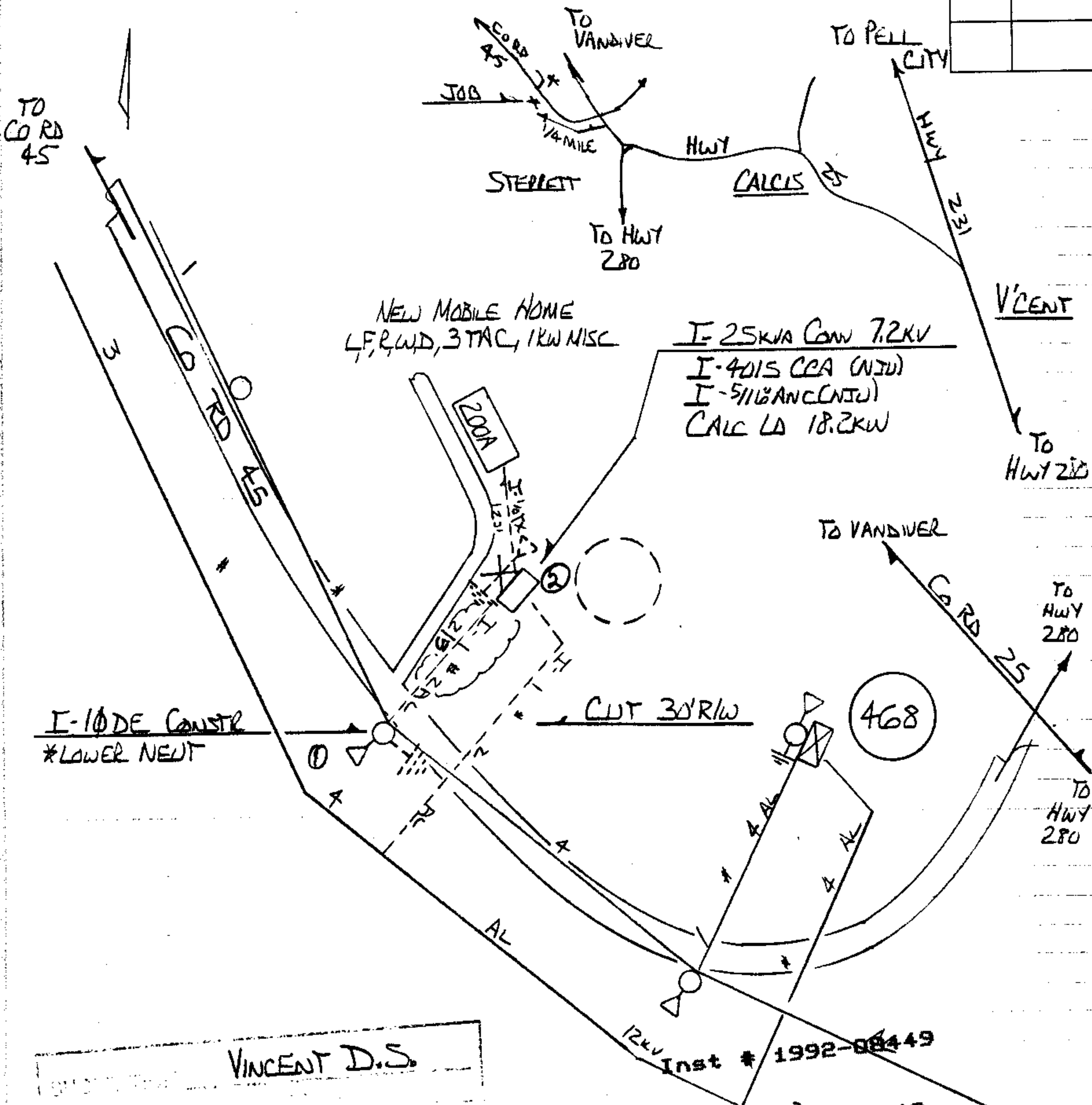

Voltage	
Pri	Sec.
7200	720/240
PHONE CO.	
Co. Name	
CATV CO.	
Co. Name	
ACCESSIBLE	
TREE CREW <input checked="" type="checkbox"/>	
ROCK HOLE	
PERMITS REQ'D	
R/W <input checked="" type="checkbox"/>	
CITY	
COUNTY	
STATE	
MISSALL # <input checked="" type="checkbox"/>	
OTHER	
SCALE	
200	
Ft. Per Inch	

VINCENT D.S.

05/15/1992-08449
02:17 PM CERTIFIED
SHELBY COUNTY JUDGE OF PROBATE

Cnst. Completed By **Sta. 1+00 to Sta. 1+60**

Rel. R/W