

543128

STATE OF ALABAMA)

County of Shelby)

WE # 61500-08-0047703

STA 12 + 00 to STA 4 + 00

1647

ALSO ALL SERVICE WIRES TO METERS

KNOW ALL MEN BY THESE PRESENTS, that the undersigned

Shoal Valley a Joint Venture

for and in consideration of the sum of One and no/100 (\$1.00), to
it in hand paid by Alabama Power Company, a corporation, the

receipt whereof is acknowledged, does hereby grant to said Alabama
Power Company, its successors and assigns, the right to
construct, install, operate and maintain, and the right to permit
other corporations and persons to construct, install, operate and
maintain along a route to be selected by the grantee, (generally
shown crosshatched on the attached drawing) its successors and
assigns, all conduits, cables, trans closures and other appliances
and facilities useful or necessary in connection therewith, for
the underground transmission and distribution of electric power
and for underground communication service, upon, under and across

the following described land situated in Shelby
County, Alabama.

The Shires Phase 2 as recorded in Map Book 13, page 86
in the probate office of Shelby County, Alabama, | \

GRANTEE'S ADDRESS
ALABAMA POWER CO.
P. O. BOX 2841
BIRMINGHAM, AL 35281
ATT: CORP. REAL ESTATE

This instrument prepared in
the Corporate Real Estate
Dept. of Alabama Power Co.
Birmingham, Ala.

By Walter Hegler

BOOK 292 PAGE 631

Together with all the rights and privileges necessary or convenient for the full enjoyment or use thereof, including the right of ingress and egress to and from said facilities and the right to excavate for installation, replacement, repair and removal thereof; and also the right to cut and keep clear all trees, underbrush, shrubbery, roots and other growth, and to keep clear any and all obstructions or obstacles of whatever character on, under or above said facilities.

TO HAVE AND TO HOLD the same to the said Company, its successors and assigns, forever.

IN WITNESS WHEREOF, the said Shoal Valley, a Joint Venture has caused this instrument to be executed in its name by DAVID F. BYERS as its MANAGING PARTNER and attested by _____ as its _____ and its corporate seal to be hereto affixed, on this 9 day of MARCH, 19 90.

ATTEST:

SHOAL VALLEY A JOINT VENTURE

David F. Byers
Managing Partner

STATE OF ALABAMA
County of SHELBY

I, L. J. JACKSON, a Notary Public, in

and for said County in said State, hereby certify that

DAVID F. BYERS whose name as
MANAGING PARTNER of said corporation, is signed

to the foregoing instrument and who is known to me, acknowledged before me on this day being informed of the contents of the instrument, he as such officer and with full authority executed the same voluntarily on the day the same bears date.

Given under my hand and official seal, this the 9 day of MARCH, 19 90.

L. J. Jackson
Notary Public
NOTARY PUBLIC STATE AT LARGE

SKETCH OF PROPOSED WORK — SIMPLIFIED W. E.

Alabama Power

Estimate No. 615000000-00477-03	Customer THE SHIRES - 2ND SECTOR	Location HWY. 41	Agreed Serv. Date
Division SHADY	District HUFFMAN	Town DUNN VANT	Drawn by HAWTHORNE
County SMELBY	Section	Township	Range
Acquisition Agent	Date R/W Assigned	Date R/W Cleared	Map Reference
			LOC
			Transformer Loading

All Loads: LF, RD, WH, STC

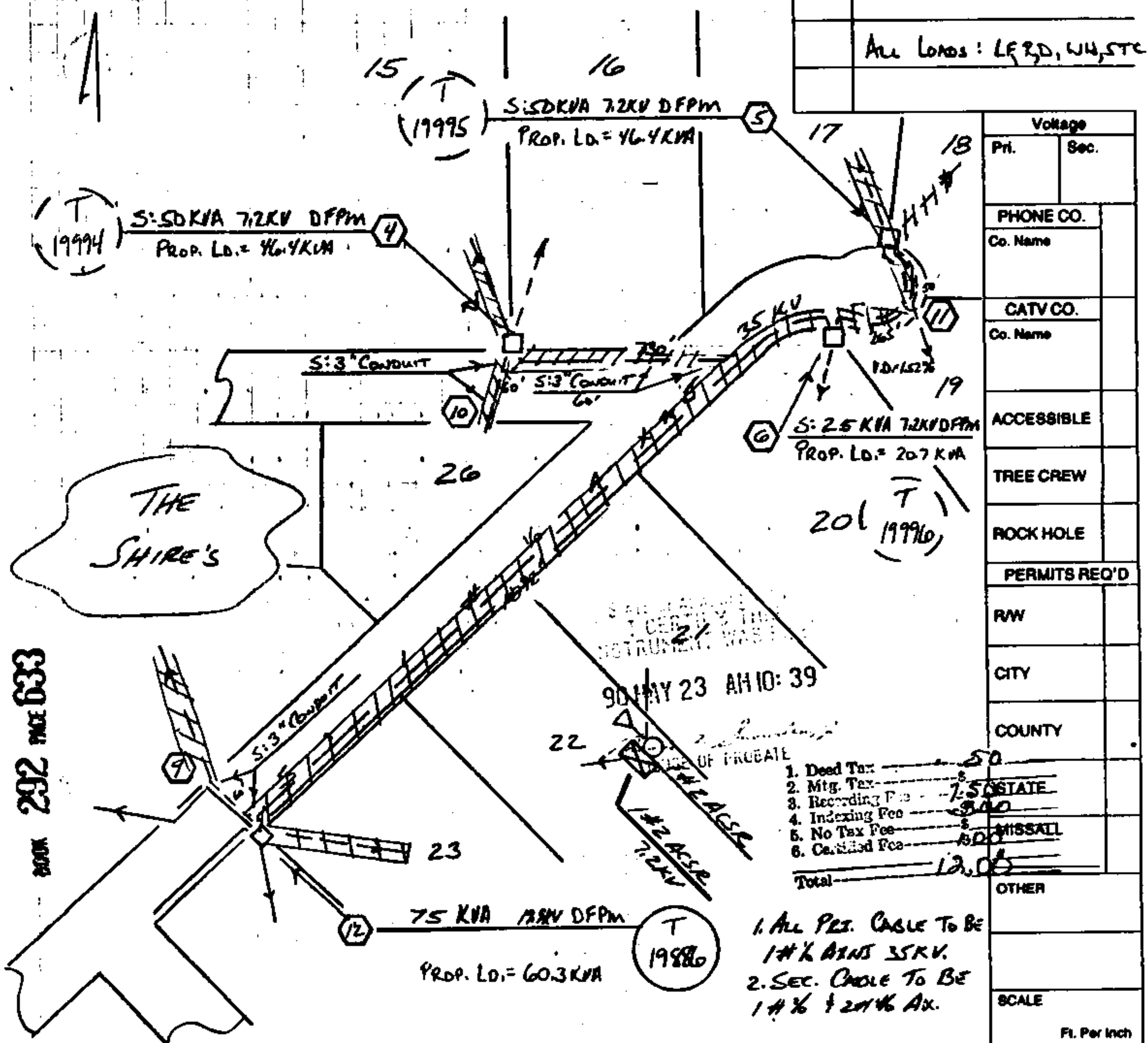

Voltage	
Pri.	Sec.
PHONE CO.	
Co. Name	
CATV CO.	
Co. Name	
ACCESSIBLE	
TREE CREW	
ROCK HOLE	
PERMITS REQ'D	
R/W	
CITY	
COUNTY	
OTHER	
SCALE	
Ft. Per Inch	

1. Deed Tax
 2. Mtg. Tax
 3. Recording Fee
 4. Indexing Fee
 5. No Tax Fee
 6. Certified Fee
- Total

1. ALL PRE. CABLE TO BE 1# 1/2 AWG 35KV.
2. SEC. CABLE TO BE 1# 1/2 + 2# 1/4 AWG.

Approved by	Date
Cnst. Completed by	Date
Engr. Completed By	Date