

528022

WE # 61700-08-0031-8-00

STATE OF ALABAMA,

759

County of SHELBY

KNOW ALL MEN BY THESE PRESENTS, that the undersigned,

LACEY & COMPANY, Inc.

in consideration of the sum of One and No/100 (\$1.00), to it in hand paid by Alabama Power Company, a corporation, the receipt whereof is acknowledged, DOES hereby grant to said Alabama Power Company, its successors and assigns, the right to construct, install, operate and maintain, and the right to permit other corporations and persons to construct, install, operate and maintain, along routes to be selected by the grantee, (generally shown crosshatched on the attached drawing) its successors or assigns, all poles, wires, conduits, cables, trans closures and other appliances and facilities useful or necessary in connection therewith for the overhead and underground transmission and distribution of electric power and for the overhead and underground communication service, upon, over, under and across the following described land, situated in SHELBY County, Alabama.

INDIAN CREST ESTATES - 1ST Addition AS RECORDED
IN MAP BOOK 12, PAGE 54 IN THE OFFICE OF THE
JUDGE OF PROBATE.

GRANTEE'S ADDRESS
ALABAMA POWER CO.
P. O. BOX 2841
BIRMINGHAM, AL 35291
ATT: CORP. REAL ESTATE

This instrument prepared in
the Corporate Real Estate
Dept. of Alabama Power Co.
Birmingham, Ala.

By R. L. COOPER

BOOK 255 PAGE 741

Together with all the rights and privileges necessary or convenient for the full enjoyment or use thereof, including the right of ingress and egress to and from said facilities and the right to excavate for installation, replacement, repair, and removal thereof; and also the right to cut and keep clear all trees, underbrush, shrubbery, roots and other growth, and to keep clear any and all obstructions or obstacles of whatever character on, under or above said facilities.

TO HAVE AND TO HOLD the same to the said Alabama Power Company, its successors and assigns forever.

IN WITNESS WHEREOF, the said LACEY & COMPANY, INC. has caused this instrument to be executed in its name by ROBERT P. LACEY as its PRESIDENT, and attested by _____ as its _____, and its corporate seal to be hereto affixed, on this the 6th day of JULY, 1988.

Attest:

Lacey and Company, Inc.
Robert P. Lacey

STATE OF ALABAMA

COUNTY OF SHELBY

I, DON D. BAILEY, a Notary Public, in and for said County in said State, hereby certify that ROBERT P. LACEY whose name as PRESIDENT of LACEY & COMPANY, INC. a corporation, is signed to the foregoing instrument, and who is known to me, acknowledged before me on this day that, being informed of the contents of this instrument, he as such officer and with full authority executed the same voluntarily for and as the act of said corporation.

Given under my hand and official seal, this the 6th day of JULY, 1988.

Don D. Bailey
Notary Public

(X)
NO352
I. 7.5 KVA 7.2 KV DEPM TRANS.
PRD. LONO = 171 KVA
APRO. CONNECT #6 CU GND. FROM
SCB REDESTRAL TO TRANS.
APRO. BILL SCB # 24.00
SLG JOB # 334-7233

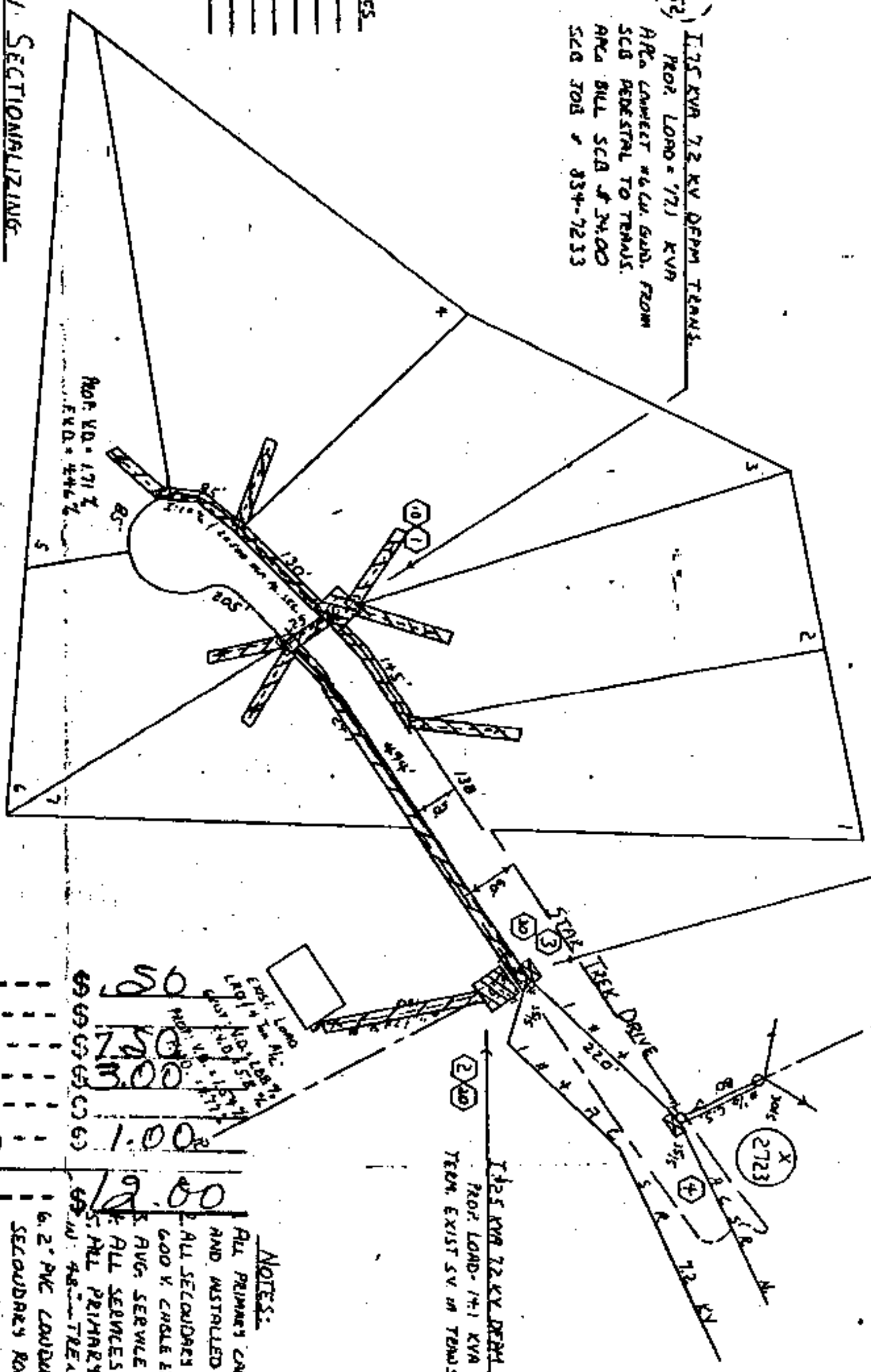

STATE OF ALA. SHELBY CO.
I CERTIFY THIS
INSTRUMENT WAS FILED
89 SEP 12 AM 9:05
Thomas A. Snowden, Jr.
JUDGE OF PROBATE

Quaint Yes
 Front, Carl
 Island Map
 Rocks
 Tree Crow
 Staged
 Arrived
 from with

12 KV. SECTORIALIZING

LOCATION SKETCH

FOREMAN: FOR HOTLINE WORK AT THIS LOCATION
PLEASE H.L. 7800 AT OLD # 3995B

To VALLEJO E.D.S.
OCB # 37958

L-6757
L-6018
NA

LOC. 1-2: MAP REF. 200-19-21-1,
200-19-21-2
MAY: RUTLAND TELSON, 6/10
MAY SWLP. 213' / ft. SEC. 21 TP 19 S R. 200

1. Deed Tax -----
2. Mtg. Tax -----
3. Recording Fee -----
4. Indexing Fee -----
5. No Tax Fee -----
6. Certified Stamp Fee --

Total

50	1.00
7.50	3.00
3.00	
1.00	

NOTES:

ALL PRIMARY CABLE TO BE 1# 60 KVA 35 KV
AND INSTALLED IN 3" PVC CONDUIT.
2. ALL SECONDARY SERVICES TO BE 1# 60 L2 # 3/0 COP AND
600 V. CABLE EXCEPT WHERE SHOWN.
3. AVG. SERVICE LENGTH TO BE 100'.
4. ALL SERVICES TO BE INSTALLED IN 3/4" TRENCH.
5. ALL PRIMARY & SECONDARY CABLE TO BE INSTALLED
IN 48" TRENCH.
6. 2" PVC CONDUIT TO BE INSTALLED IN 1# 60 & 2# 3/0
SECONDARY ROAD CROSSINGS AND UNDER DRIVEWAYS
7. 3" PVC CONDUIT BE BE INSTALLED IN 1# 60 & 2# 3/0
KCM AL. SECONDARY CROSSINGS UNDER DRIVEWAYS
8. AFTER CONSTRUCTION TO REFORM ALL TRENCHING, INSULATING,
TRANSFORMER PADS, GROUND RODS, PRIMARY, SEC-
ONDARY, AND SERVICE CONDUCTORS.
9. TRANSFORMER LOADING BASED ON L.R.O. 500 VA

ALABAMA POWER COMPANY

200 NORTH SHILOH 12 KY DISTRIBUTION
DETAIL - INDIANA CREST ESTATES - 7ST ADDITION
710TS - HRD

SCALE 1" = 100' SHEET 1 OF 1 SHEETS
SUPERSEDES
F-67100-08-00318-C