

526526

GRANTEE'S ADDRESS
ALABAMA POWER CO.
P. O. BOX 2641
BIRMINGHAM, AL 35291
ATT: CORP. REAL ESTATE

This instrument prepared in
the Corporate Real Estate
Dept. of Alabama Power Co.
Birmingham, Ala.

R.C. Coggia

268

STATE OF ALABAMA)

WE NUMBER 64600-00-0047-800

COUNTY OF SHELBY)

KNOW ALL MEN BY THESE PRESENTS, that the undersigned,

William H. Parker, a single man

in consideration of the sum of One and No/100 Dollars (\$1.00) to me
in hand paid by Alabama Power Company, a corporation, the receipt whereof
is acknowledged, does hereby grant to said Alabama Power Company, its
successors and assigns, the right to construct, install, operate and maintain,
and the right to permit other corporations and persons to construct, install,
operate and maintain, along routes to be selected by the grantee (generally
shown crosshatched on the attached drawing), its successors or assigns,
all poles, wires, conduits, cables, trans closures and other appliances
and facilities useful or necessary in connection therewith for the overhead
and underground transmission and distribution of electric power and for
the overhead and underground communication service, upon, over, under and
across the following described land, situated in Shelby County,
Alabama:

A parcel of land in the NE $\frac{1}{4}$ of the SW $\frac{1}{4}$ of Section 24, Township 19
South, Range 1 East more particularly described as follows:

Commence at the SW corner of the said forty and run East along the
South line of said forty for a distance of 825 feet for a point of
beginning; thence continue the last described course 495 feet to the SE
corner of said forty; thence run North along the east line of said
forty to the point of intersection with the south right of way of Old
U.S. Highway #280; thence run West along the said south right of way a
distance of 295 feet; thence run South parallel to the east line of
said forty for a distance of 350 feet; thence run West parallel to the
south line of said forty for a distance of 200 feet; thence run South
parallel to the east line of said forty to the point of beginning.

Together with all the rights and privileges necessary or convenient for the full enjoyment or use thereof, including the right of ingress and egress to and from said facilities and the right to excavate for installation, replacement, repair and removal thereof; and also the right to cut and keep clear all trees, underbrush, shrubbery, roots and other growth, and to keep clear any and all obstructions or obstacles of whatever character on, under or above said facilities.

TO HAVE AND TO HOLD the same to the said Company, its successors and assigns, forever.

IN WITNESS WHEREOF, we have hereunto set our hands and seals, this the

16th day of February, 1928.

WITNESS:

Stella Townley

William H. Parks (Seal)

Lilly Esperson

____ (Seal)

STATE OF)

COUNTY OF)

I, _____, a Notary Public, in and for said County in said State, hereby certify that _____

_____ whose name _____ signed to the foregoing instrument and who _____ known to me, acknowledged before me on this day that being informed of the contents of the instrument _____ executed the same voluntarily, on the day the same bears date.

Given under my hand and official seal, this the _____ day of

_____, 19____.

BOOK 236 PAGE 945

$$\begin{array}{r} X \\ Y \\ \hline Z \end{array} \quad \begin{array}{r} 52472 \\ 17935 \\ \hline XD \end{array}$$

MIJAN I. DADKHA
LEONARD F. DUCKWISS
GTC-5315

35 KN-CN-LA SEE
WESTONER, ALA

STATE OF ALA. SHELBY CO.
I CERTIFY THIS
INSTRUMENT WAS FILED
89 MAY -3 AM 9:26

9 MAY -3 AM 9:26

JUDGE OF PROBATE

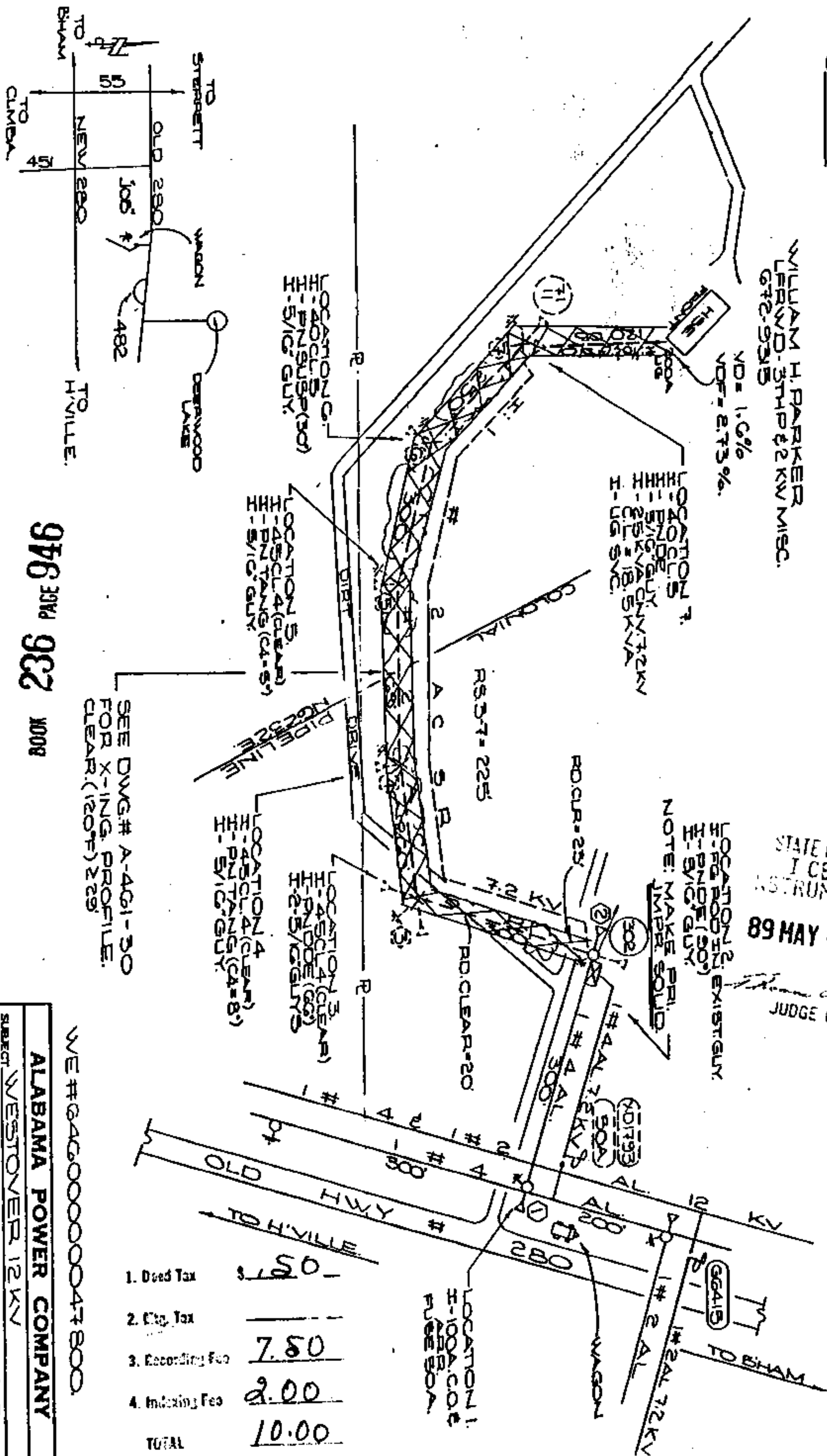

1. Used Tax	\$ <u>1.20</u>
2. City Tax	<u> </u>
3. Recording Fee	<u>7.50</u>
4. Indexing Fee	<u>2.00</u>
TOTAL	<u>10.00</u>

WE#6460000047800

ALABAMA POWER COMPANY

SUBJECT WESTONER 12 KN
DETAIL PROVIDE ELEC. SVC. FOR
WILLIAM H. PARKER.

SCALE NTS
SHEET 1 OF 1 SHEETS
SUPPLEMENT

B-461-56.

SHELLEY COUNTY
S.24, T19S, R1E
C-M-D-CAT03#11

C-100-00-71
 DRAWING DATE _____
 CHECKED _____ DATE _____
 APPROVED _____ DATE _____

BOOK 236 PAGE 946