

654

State of Alabama

WE # 61700-00-0126-6-00

County of Shelby

483073

KNOW ALL MEN BY THESE PRESENTS, that the undersigned,

William L. Seefeld & WIFE,

HENRI J. SEEFELD

for and in consideration of the sum of One and No/100 Dollars (\$1.00), to
us in hand paid by Alabama Power Company, a corporation, the receipt
whereof is acknowledged, do hereby grant to said Alabama Power Company,
its successors and assigned, the right to construct, install, operate and
maintain, and the right to permit other corporations and persons to construct,
install, operate and maintain along a route to be selected by the grantee,
(generally shown crosshatched on the attached drawing) its successors and
assigns, all conduits, cables, trans closures and other appliances and
facilities useful or necessary in connection therewith, for the underground
transmission and distribution of electric power and for underground communi-
cation service, upon, under and across the following described land situated
in Shelby County, Alabama:

LOT # 20, HAVENWOOD PARK - 1ST Sector
AS RECORDED IN MAP BOOK 9, PAGE 106
IN THE OFFICE OF THE JUDGE OF PROBATE.

This instrument prepared in
the Corporate Real Estate
Dept. of Alabama Power Co.
Birmingham, Ala.

By R. C. Coggins

GRANTEE'S ADDRESS
ALABAMA POWER CO.
P. O. BOX 2641
BIRMINGHAM, AL 35291
ATT: CORP. REAL ESTATE

BOOK 075 PAGE 711

04

Together with all the rights and privileges necessary or convenient for the full enjoyment or use thereof, including the right of ingress and egress to and from said facilities and the right to excavate for installation, replacement, repair and removal thereof; and also the right to cut and keep, clear all trees, underbrush, shrubbery, roots and other growth, and to keep clear any and all obstructions or obstacles of whatever character on, under or above said facilities.

TO HAVE AND TO HOLD the same to the said Company, its successors and assigns, forever.

IN WITNESS WHEREOF, we have hereunto set our hands and seals, this the 30th day of April, 1986.

WITNESS:

L. E. Echeverri
Carolyn Appleton

W. L. Seefeld (Seal)
Henriette Seefeld (Seal)

STATE OF Alabama)
COUNTY OF Shelby)

I, Donna R. Catton, a Notary Public, in and for said County in said State, hereby certify that W. L. Seefeld and Henriette Seefeld whose names Signed to the foregoing instrument and who is known to me, acknowledged before me on this day that being informed of the contents of the instrument they executed the same voluntarily, on the day the same bears date.

Given under my hand and official seal, this the 10th day of

May, 1986.

Donna R. Catton
My Commission Expires 2-25-87

SKETCH OF PROPOSED WORK

Alabama Power

WE No.

61700-00-01266-00

Division

BIRMINGHAM

Estimate No	Estimate Description	Estimate Amount	Estimate Date	Estimate Status
1
2
3
4
5
6
7
8
9
10
11
12
13
14
15
16
17
18
19
20
21
22
23
24
25
26
27
28
29
30
31
32
33
34
35
36
37
38
39
40
41
42
43
44
45
46
47
48
49
50
51
52
53
54
55
56
57
58
59
60
61
62
63
64
65
66
67
68
69
70
71
72
73
74
75
76
77
78
79
80
81
82
83
84
85
86
87
88
89
90
91
92
93
94
95
96
97
98
99
100

Town INDIAN VALLEY

District
NORTH SHELBY

Drawn By
K.L. NOLAN

Date 4-11-86

Scale *NTS* Ft. Per Inch

Soci.

Township
19 S

Range 2W

Map Reference
71845-36

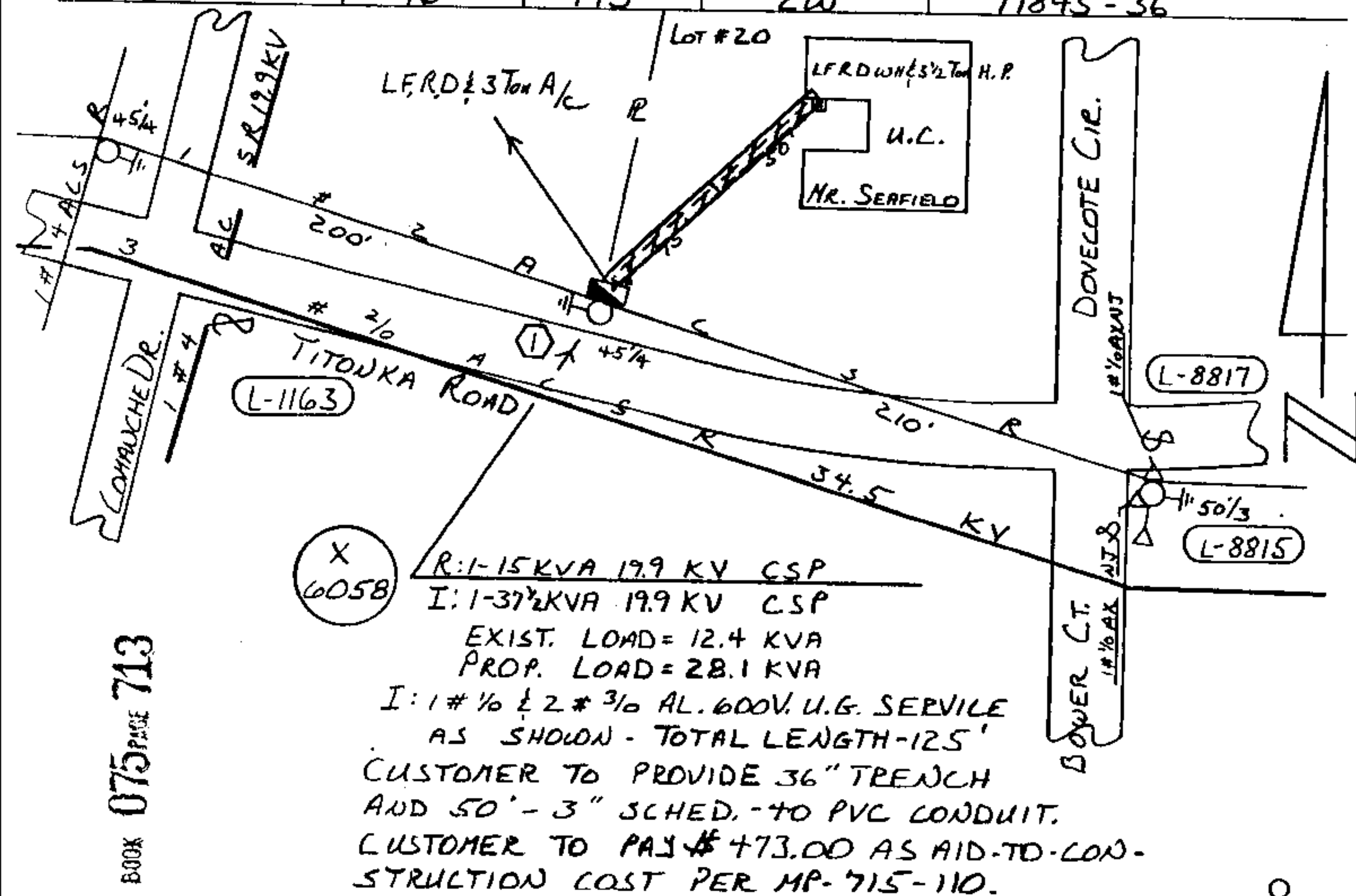

STATE OF ALA. SHELBY CO.
I CERTIFY THIS
INSTRUMENT WAS FILED

1986 JUN 10 AM 10: 45

Thomas C. Lawrence, Jr.
JUDGE OF THE PAIR

1. Deed Tax \$.50

2. Mtg. Tax

3. Recording Fee 7.50

4. Indexing Fee 4.00

TOTAL

Bucket yes
Transf. Cart _____
Hand Hole _____
Rock _____
Tree Crew _____
Staked _____
Permit _____
Work with _____

