

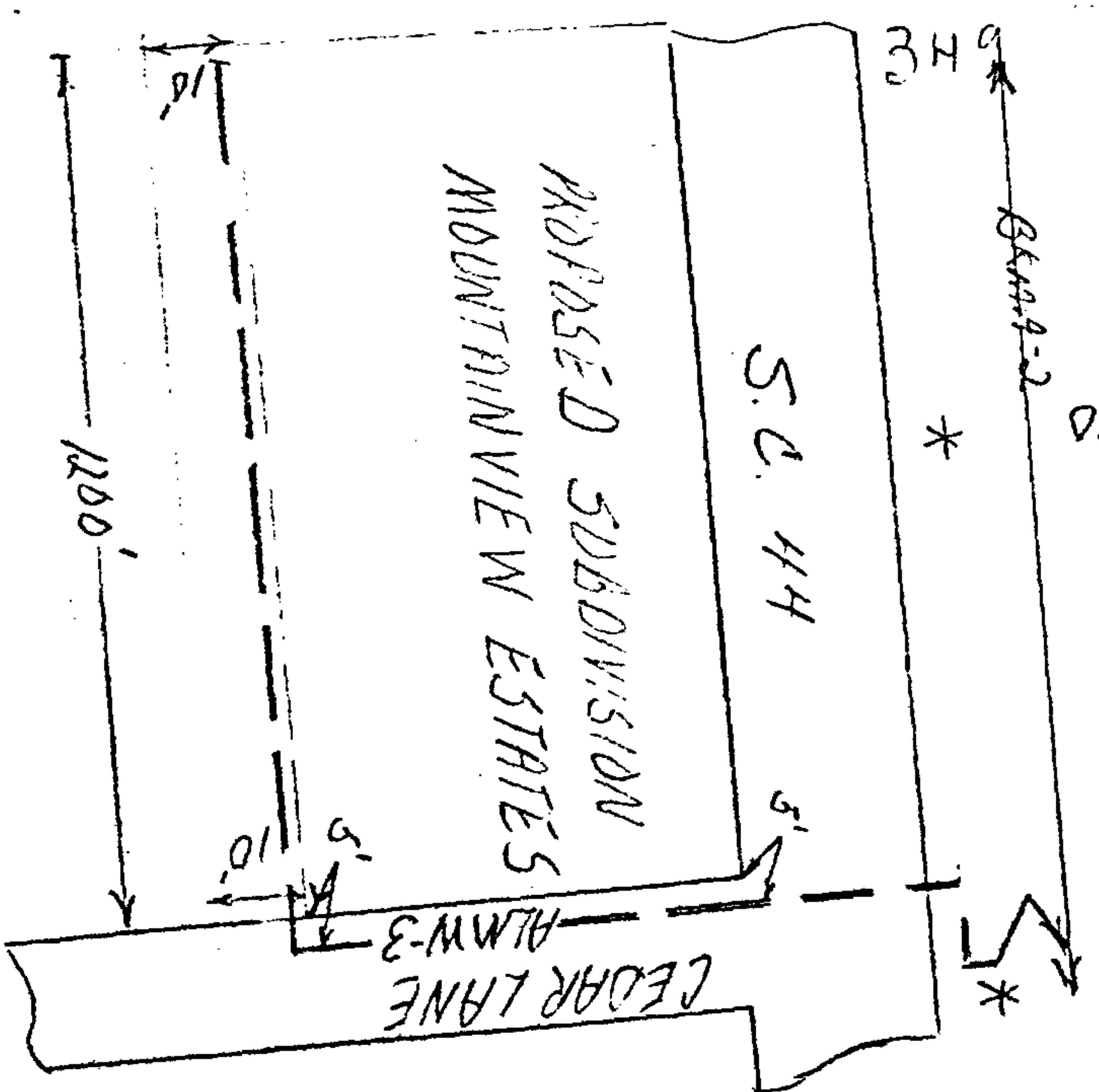

19800212000017060 Pg 1/1 .00
Shelby Cnty Judge of Probate, AL
02/12/1980 00:00:00 FILED/CERTIFIED



Name and Post Office Address of Grantor WILLIAMS
P.O. BOX 286
ALBANY, GA 31707
Toll Line (Name) ALBANY
Exchange Line (Name) ALBANY
tributary to (Exchange)
The property is bounded where the line enters and leaves this property by the property of: WILLIAMS of the WEST
The poles (or stakes) have the following identification: DATE 19 5 11 114
to Authority 434-843 classification 1100
Area 100
Approved W. P. Williams
Title DIST. MGR. - OSP ENGRG.
NORTH

RIGHT-OF-WAY EASEMENT

FORM 8416 SC
MARCH, 1973

In consideration of the sum of money hereinafter set out and other good and valuable consideration, the adequacy and receipt of which is hereby acknowledged from the South Central Bell Telephone Company, the undersigned, owner(s) of the premises described below, do hereby grant to the South Central Bell Telephone Company, its licenses, agents, successors, assigns, and allied and associated companies, a right of way easement to construct, operate, maintain, add or remove such lines or systems of communications or related services as the grantee may require, consisting of:

- (1) poles, guys, anchors, aerial cables and wires;
- (2) Buried cables and wires, cable terminals, markers, splicing boxes and pedestals;
- (3) Conduits, manholes, markers, underground cables and wires;
- (4) and other amplifiers, boxes, appurtenances or devices

upon over and under a strip of land 10 feet wide across the following lands in Shelby County, State of ALA. generally described as follows: 1200 ft of land located off
Shelby County 44, near Cedar Lane. Location is proposed Subdivision Mountainview Estates,
TOWNSHIP 21 SOUTH, RANGE 3 WEST, SECTION 34.

and, to the fullest extent the undersigned has the power to grant, if at all, over, along and under the roads, streets, or highways adjoining or through said property.

The following rights are also granted: to allow any other person or company to attach wires or lay cable or conduit within the right of way for communications or electric power transmission or distribution; ingress and egress to said premises at all times; to clear the land and keep it cleared of all trees, undergrowth or other obstructions within the easement area; to trim and cut and keep trimmed and cut all dead, weak, leaning or dangerous trees or limbs outside of the easement area which might interfere with or fall upon the lines or systems of communications or power transmission or distribution.

The receipt of ONE and 100 /100 Dollars (\$100) is hereby acknowledged by the undersigned.

To have and to hold the above granted easement unto South Central Bell Telephone Company, its successors and assigns forever.

signed and sealed this document

IN WITNESS WHEREOF, the undersigned has caused this instrument to be executed by its
on Sept 21, 1979 duly authorized agent

Signed, sealed and delivered in the presence of: W. P. Williams L.S.
Witness JOSEPH TINS see p. 50
see p. 1.50 L.S.

1980 FEB 12 AM 8:40 300

Attest Thomas G. Shaw By W. P. Williams
Corporate Officer Title: